

# ARI RP500 /RP501

## SIZE

1/2", 3/4", 1", 1 1/4", 1 1/2", 2"

## DESCRIPTION

This is a reduced pressure assembly. Production began in 2007. The body is made of a UV resistant glass reinforced nylon. There is a single access cover. The checks are an in-line modular design. There will be RV spring tension when the cover is removed. The RV stem is mounted between the check assemblies. The checks are an in-line modular design held in the body by a retainer. In 2016 the Model RP501 was introduced which contains union end nylon shutoffs.

## BASIC REPAIR KIT

The kit contains discs, diaphragm, and O'rings

### SIZE

1/2"-1"  
1 1/4"-2"

### KIT NO

0466-565499-01K  
0466-565499-02K

## IMPORTANT FEATURES

- ~Plastic body construction*
- ~Inline check design*
- ~Factory repair information enclosed*



# A.R.I. RP-500 Reduced Pressure Backflow Preventer

FLOW CONTROL ACCESSORIES Ltd.

## Main Features

- Working Pressure: 150 psi.
- Sizes: 1/2", 3/4", 1", 1 1/4", 1 1/2", 2".
- Temp: 33° to 110° f.
- Made of composite plastic material: resistant to corrosion, scaling, fertilizers, herbicides, insecticides, etc.
- Internal control system ensures reliability and safety.

### MATERIALS:

- Body..... Polyamide 6.50% Glass Reinforced Nylon
- Cover..... Polyamide 6.50% Glass Reinforced Nylon
- Polymers... Noryl, NSF Listed
- Elastomers... Silicone
- Springs..... Stainless Steel

Sizes: 1/2" – 2"

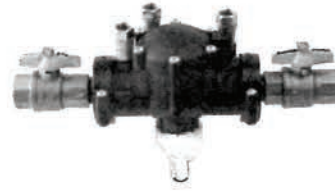

By Models	Dimensions Inch			Weight Lbs.
	A	B	C	
<b>RP-501</b>				
Nylon Shut-Off Valve				
3/4"	12.60	6.69	3.94	2.60
1"	14.17	6.69	3.94	3.21
1 1/4"	18.27	9.57	5.91	8.55
1 1/2"	20.47	9.57	5.91	8.94
2"	21.53	9.57	5.91	9.04

## HEAD LOSS

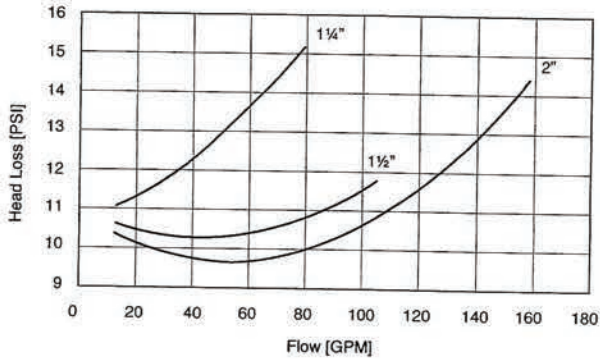
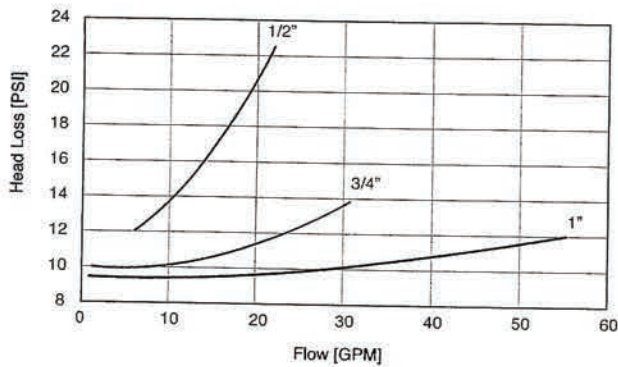

By Models	Dimensions Inch			Weight Lbs.
	A	B	C	
<b>RP-500</b>				
Lead Free Bronze Shut-Off Valve				
1/2"	11.81	6.69	3.94	3.20
3/4"	12.40	6.69	3.94	3.20
1"	12.99	6.69	3.94	3.35
1 1/4"	18.50	9.57	5.91	11.68
1 1/2"	19.02	9.57	5.91	13.23
2"	20.28	9.57	5.91	14.07

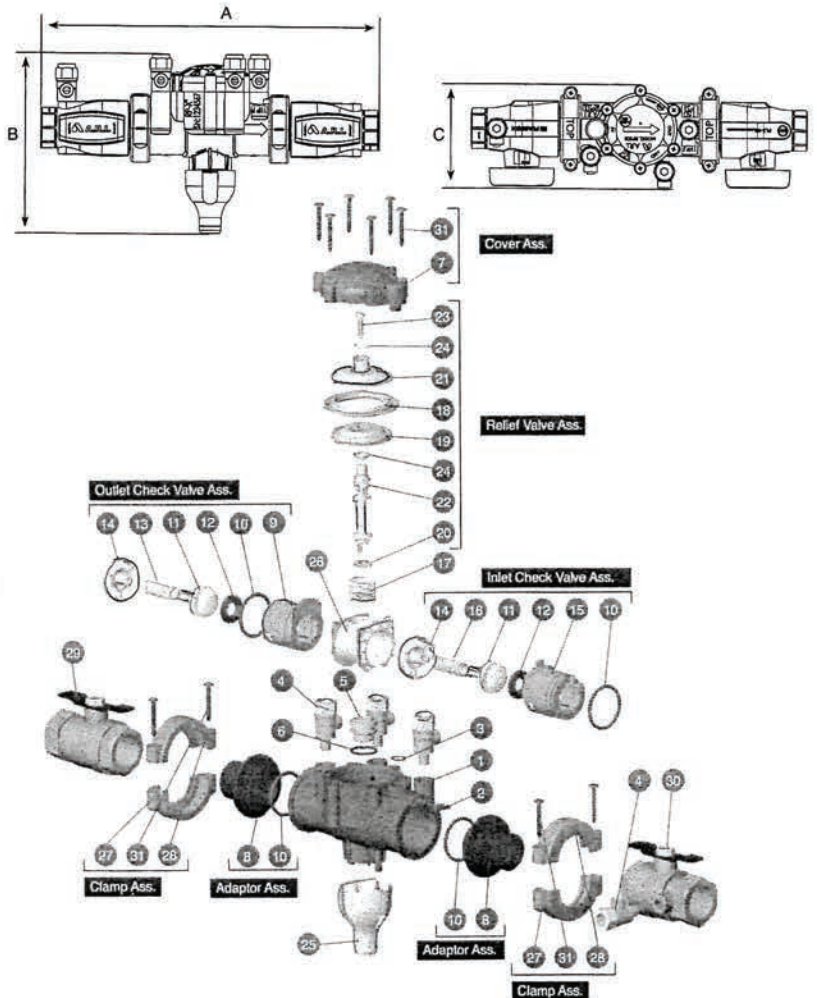

Item Numbre	Part
1	Body
2	Plug
3	O-Ring
4	Test Cock
5	Nozzle
6	O-Ring
7	Cover
8	Adaptor Insert 1" NPT
	Adaptor Insert 3/4" NPT
9	Outlet Check Valve Body
10	O-Ring
11	Check Valve Piston
12	Check Valve Seal
13	Outlet Spring
14	Check Valve Lock
15	Inlet Check Valve Body
16	Inlet Spring

Item Numbre	Part
17	Relief Valve Spring
18	Diaphragm
19	Relief Valve Bottom Lock
20	Relief Valve Road Seal
21	Relief Valve Upper Lock
22	Relief Valve Rod
23	Relief Valve Screw
24	O-Ring
25	Drainage Funnel
26	Retainer
27	Lower Clamp
28	Upper Clamp
29	Outlet Shut Off Valve 1" NPT
	Outlet Shut Off Valve 3/4" NPT
30	Inlet Shut Off Valve 1" NPT
	Inlet Shut Off Valve 3/4" NPT
31	Screws