

Model A200

Sizes: 3/4" thru 2"

PRESSURE VACUUM BREAKER

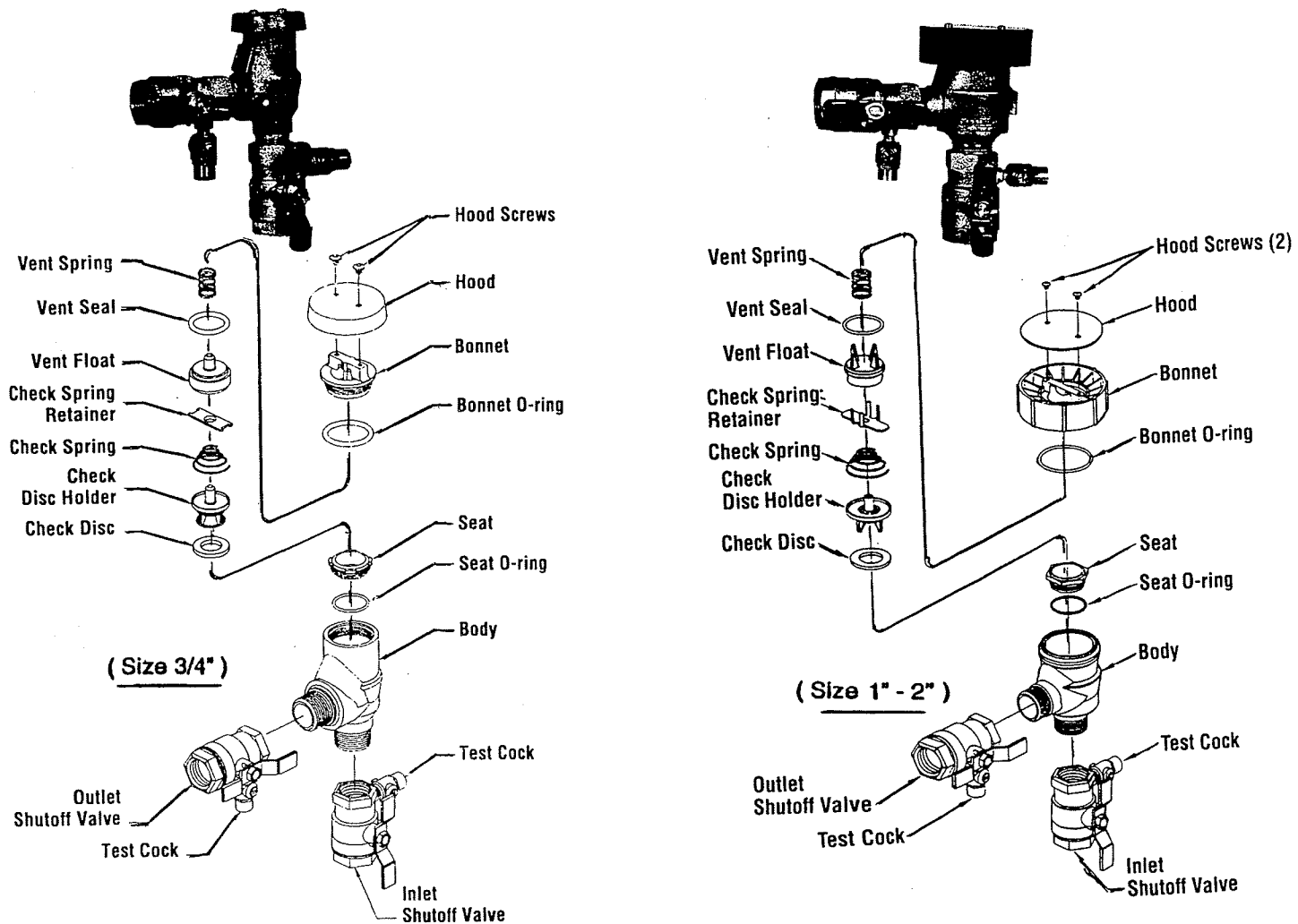

**Internal parts can be removed, repaired or inspected
without removing the valve from the piping.**

Disassembly:

1. Shut off the supply pressure and drain the valve.
2. Remove the two hood screws and the hood.
3. Place a wrench on the parallel flats of bonnet and stem assembly. Turn counter clockwise and remove.
4. Remove the vent assembly.
5. Press down on the spring retainer and disengage it from the retaining lugs. Then turn 90° and remove.
6. Remove the spring retainer and spring. Note that the large diameter of the spring is down on the guide assembly.
7. Remove the check disc holder and guide assembly.
8. Disassemble the check disc holder assembly.

Reassembly:

Reassemble in the reverse order utilizing the new parts from the repair kit.

Note: Ames assemblies require minimum maintenance. All assemblies must be retested once maintenance has been performed prior to use.