

Series 007 DOUBLE CHECK VALVE ASSEMBLY

Sizes: 1/2" thru 2"

Servicing the First and Second Check Valves:

1. After removing the cover, remove the retainers for the body bore. The check valve modules can now be removed from the valve by hand or with a screwdriver. **Note:** For Series 007 sizes 3/4"-2", the seats and springs of the first and second check modules are **not** interchangeable. The heavier spring and smaller diameter seat belong with the first check module. Series 007M1 sizes 3/4"-1" and Series 007M2 3/4" have interchangeable seats and springs.
2. The check seats are attached to the cage with a bayonet type locking arrangement. Holding the cage in one hand, push the seat inward and rotate counter-clockwise against the cage, for Series 007M2 pull apart seat and cage. The seat, cage, spring and disc assembly are now individual components.

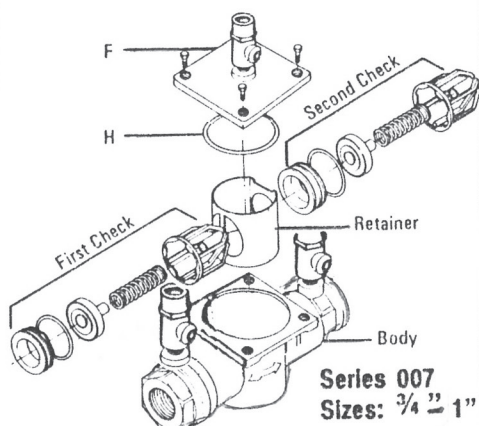
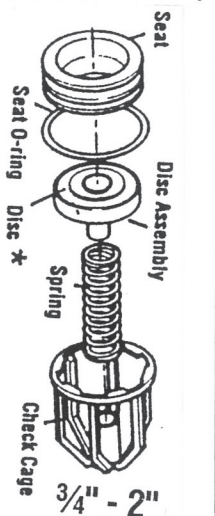

3. The disc assembly may now be cleaned and re-assembled or, depending on its condition, it may be discarded and replaced with a new assembly from the repair kit. O-rings should be cleaned or replaced as necessary and lightly greased with the FDA approved silicon grease furnished with the service kit.
4. Re-assemble the check valve module in the reverse order. Check modules are installed in the valve body with the seats facing the valve inlet. The modules must be securely in place before the retainer can be replaced. On the 3/4"-1" size, this retainer may have to be tilted slightly into place. Replace cover.

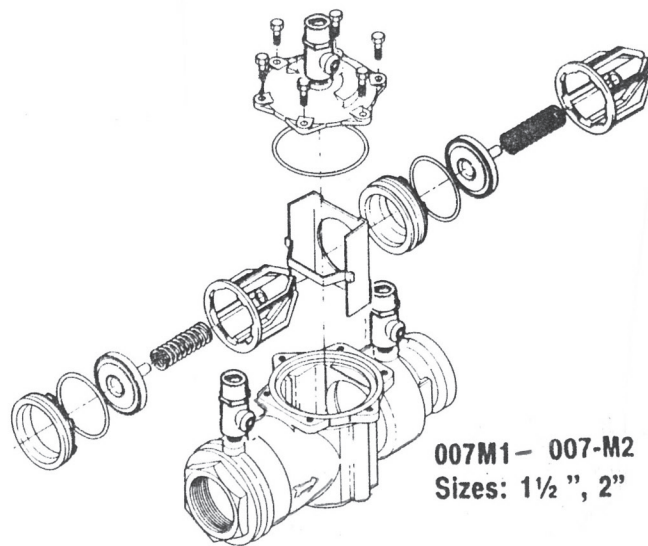
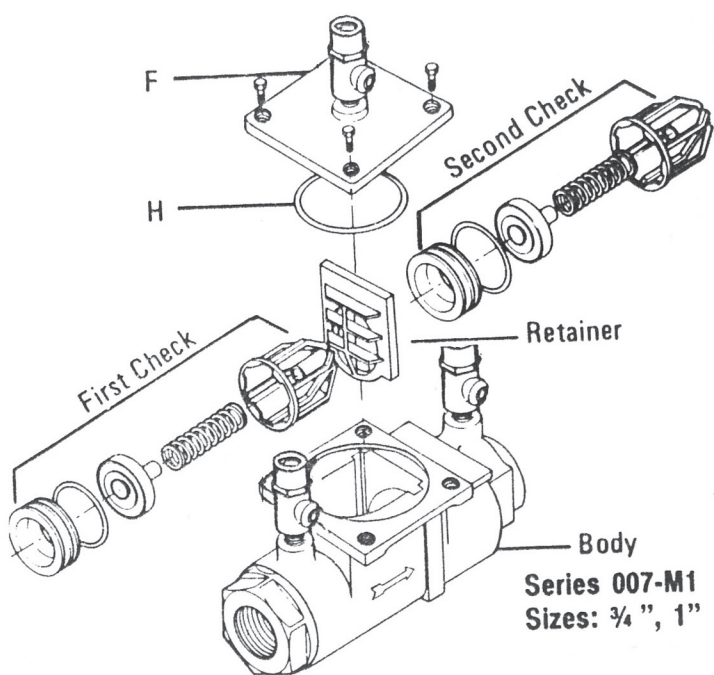
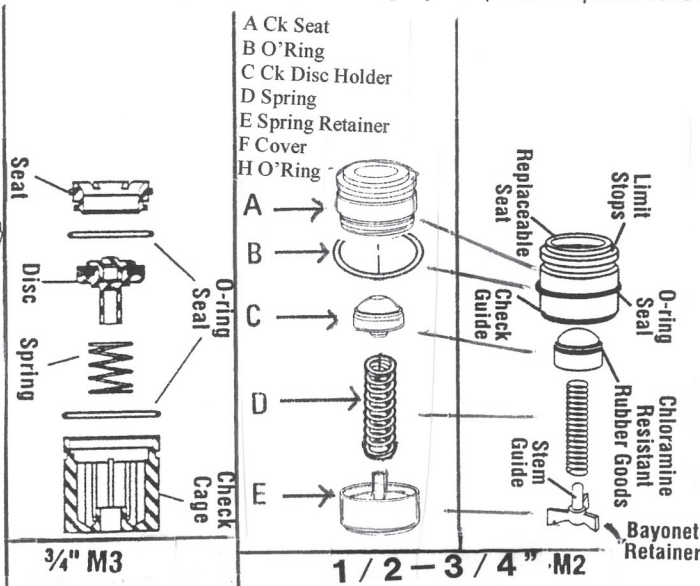

CHECK ASSEMBLY (1" - 2")

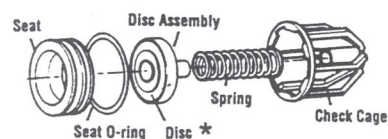

Series 007

DOUBLE CHECK VALVE ASSEMBLY

Sizes: 2½" and 3"

1. Remove cover bolts and cover.
2. Remove the retainer from the body bore. The check valve modules can now be removed from the valve by hand or with a screwdriver. **Note:** The seats and springs of the first and second check modules are **not** interchangeable. The heavier spring and smaller diameter seat belong with the first check module.
3. The check seats are attached to the cage with a bayonet type locking arrangement. Holding the cage in one hand, push the seat inward and rotate counter-clockwise against the cage. The seat, spring cage, spring and disc assembly are now individual components.
4. The disc assembly may now be cleaned and re-assembled or, depending on its condition, may be discarded and replaced with a new assembly from the repair kit. "O" rings should be cleaned or replaced as necessary and lightly greased with the FDA approved silicon grease furnished with the service kit.
5. Re-assemble the check valve modules. Check modules are installed in the valve body with the seats facing the valve inlet. The modules must be securely in place before the retainer can be replaced. On the ¾" and 1" size, this retainer may have to be tilted slightly into place.

NOTE: No special tools required to service Series 007 2½" - 3"

FIRST CHECK

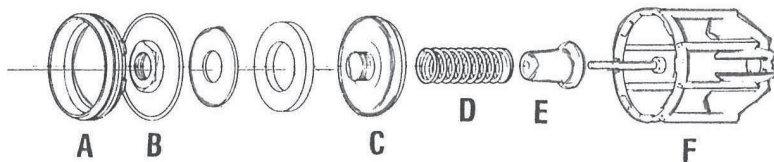

A Ck Seat
B O'Ring
C Ck Disc Holder
D Spring
E Guide
F Spring Retainer

SECOND CHECK

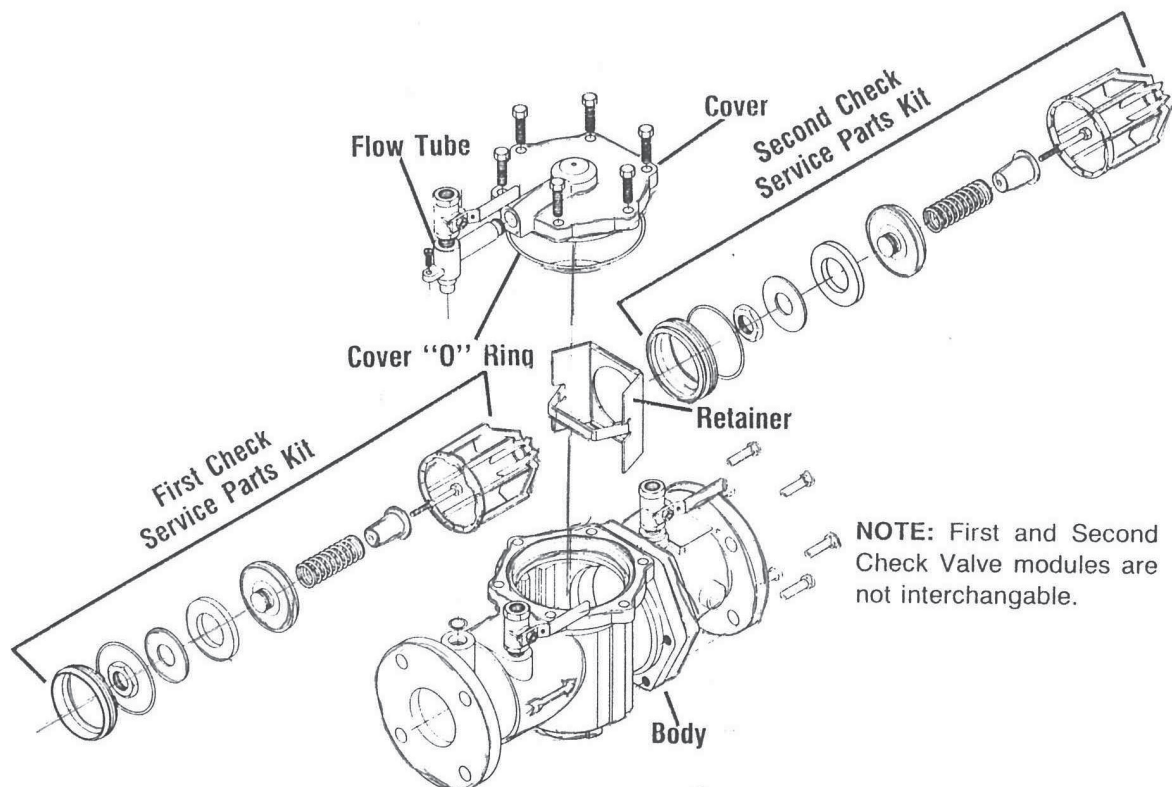
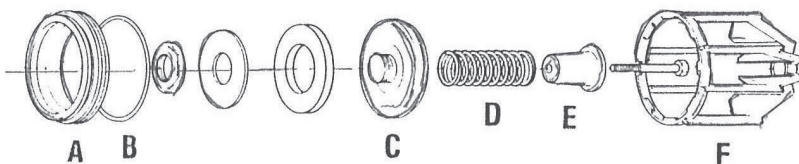

NOTE: First and Second Check Valve modules are not interchangeable.