

1. Slowly open all ball valves to relieve air and water pressure. Loosen bolts on groove coupler and remove groove coupler and cover plate from valve body.
2. Remove #1 Check assembly by using your hands to unscrew (turn counter-clockwise) Check and remove through top access port. Do not use Arm as a handle to unscrew. If Check can not be loosened by hand, insert a long screwdriver between valve body and Check (see Figure 3). Slowly apply pressure against the Check until loosened. Finish unscrewing by hand. Unscrew #2 Check (turn counter clock-wise) by placing a long screwdriver between lugs and applying pressure to loosen #2 Check. Finish unscrewing by hand.
3. To clean #1 Check, (6" and 8" only) locate the Check Arm opening stud on the outlet flange of the valve assembly. Slide the Check Arm over the stud with the check threads facing downward (Figure 1). Tighten 1/4" nut on stud to secure Check bar.

Slowly pull the assembly outward to open check allowing exposure of the seat and clapper contact area for cleaning. To clean #2 Check, lift Check Arm and hold in open position. Raise clapper so that the end of the Check Arm rests between roller and clapper (Figure 2). Thoroughly clean the seat area and clapper sealing surfaces of both Checks. Inspect seats, clapper sealing surfaces, Check Arms, and O-rings for damage. If not damaged gently close the clapper. If damaged, install a new Check assembly and/or O-ring.

4. Before reinstallation of Checks thoroughly clean o-ring groove and lubricate o-ring w/FDA approved lubricant. Insert and thread #2 Check first and then #1 Check. #2 Check should be tightened by inserting a long screwdriver between lugs to tighten firmly. Do not over tighten. Tighten #1 Check firmly by hand only. Replace cover plate, clean groove coupler gasket and groove, replace groove coupler.

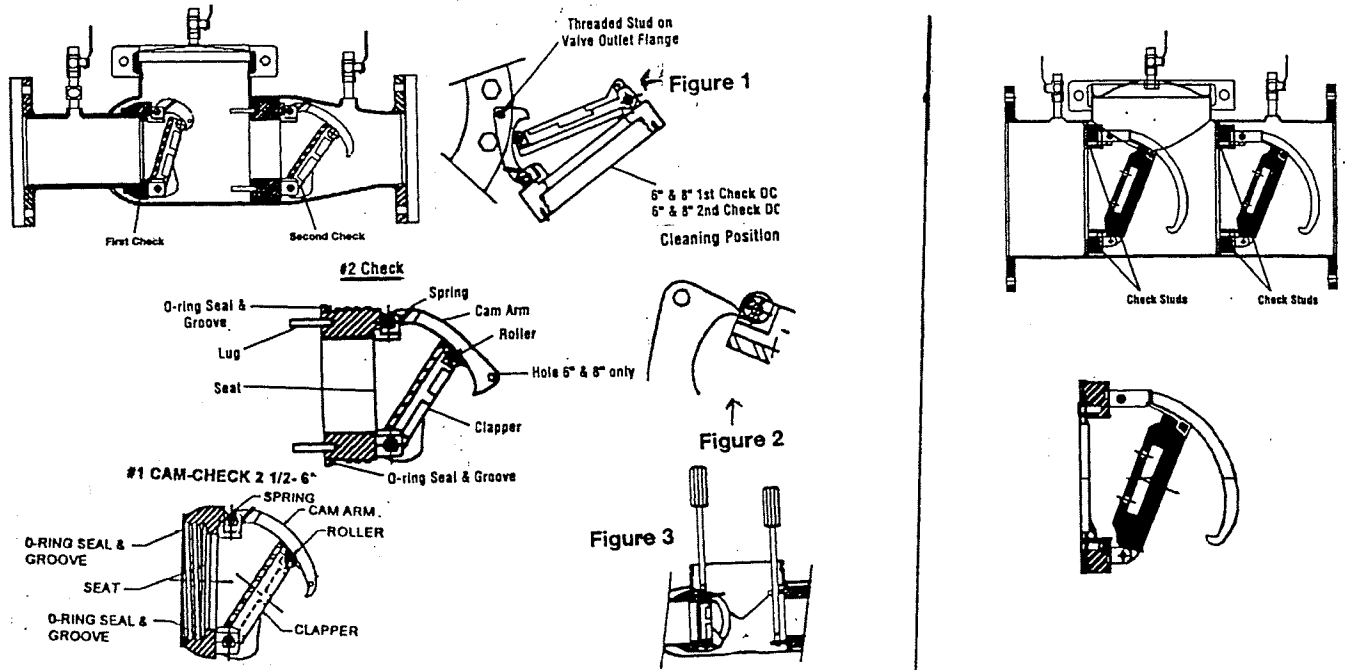

775 1/2 - 2"

Servicing the First and Second Check Valves:

1. Close shutoff valves and open test cocks No. 2, 3 and 4 to relief pressure from the body of the valve. Loosen cover bolts and remove cover. The check valve modules can now be removed from the valve by hand or with a screwdriver. Note: The first and second check assemblies are not interchangeable and the first check assembly must be removed prior to removing the second check assembly.
2. The check seats are attached to the cage with a bayonet type locking arrangement. Holding the cage in one hand, push the seat inward and rotate counterclockwise against the cage. The seat, cage, spring and disc assembly are now individual components.
3. The disc assembly may now be cleaned and reassembled or, depending on its condition, it may be replaced with a new assembly from a repair kit. Seat O-rings should be inspected and replaced as necessary.
4. Reassemble the check module in the reverse order. Install the check modules into the valve body hand-tight. Replace the cover.

(Before servicing be certain water is turned off or shut-off valves are closed)

