

SMR 701

SMR 701S

SIZE

1/2", 3/4", 1"

DESCRIPTION

The Model 701 is a pressure vacuum breaker. It was produced from approximately 1955-1977. It was produced originally under the SMR name and later sold to the Neptune Co. who also produced it. Either name may be on the unit. The assembly was originally produced without an air inlet spring. A field modification was introduced in 1978 to give it a one pound minimum air inlet loading. The S designation on the model number means the air inlet is spring loaded. The body was made of bronze. Check seats are cast in the body and are not replaceable. The check spring was contained when the bonnet was removed.

BASIC REPAIR KIT

The repair kit contains check assembly, check spring, O'ring, float and float spring.

SIZE

1/2"-1"

KIT NO

701100 *◆

IMPORTANT FEATURES

- ~ Bronze body
- ~ Check seat is not replaceable
- ~ Check spring is contained when bonnet is removed
- ~ Air inlet may be spring loaded or not depending on field modification

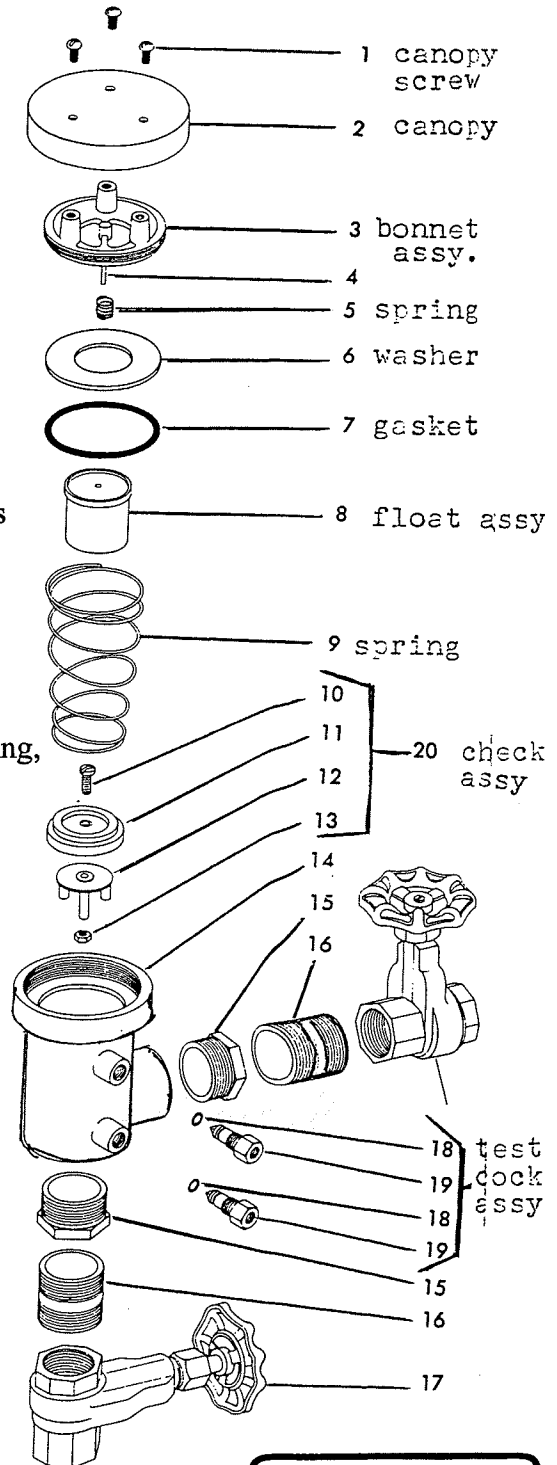

SMR 711

SMR 711S

SIZE

1 1/4", 1 1/2", 2"

DESCRIPTION

the Model 711 is a pressure vacuum breaker. It was produced from approximately 1955-1977. It was produced originally under the SMR name and later sold to the Neptune Co. who also produced it. Either name may be on the unit. The assembly was originally produced without an air inlet spring. A field modification was introduced in 1978 to give it a one pound minimum air inlet loading. The S designation on the model number means the air inlet is spring loaded. The body is made of bronze. Check seats are cast in the body and are not replaceable. The check spring was contained when the bonnet was removed.

BASIC REPAIR KIT

The repair kit contains check assembly, check spring, float and cover gasket.

SIZE

1 1/2"-2"

KIT NO

711200 *◆

IMPORTANT FEATURES

~ Bronze Body

~ Check seat is not replaceable

~ Check spring is contained

~ Air inlet may be spring loaded or not depending on field modification

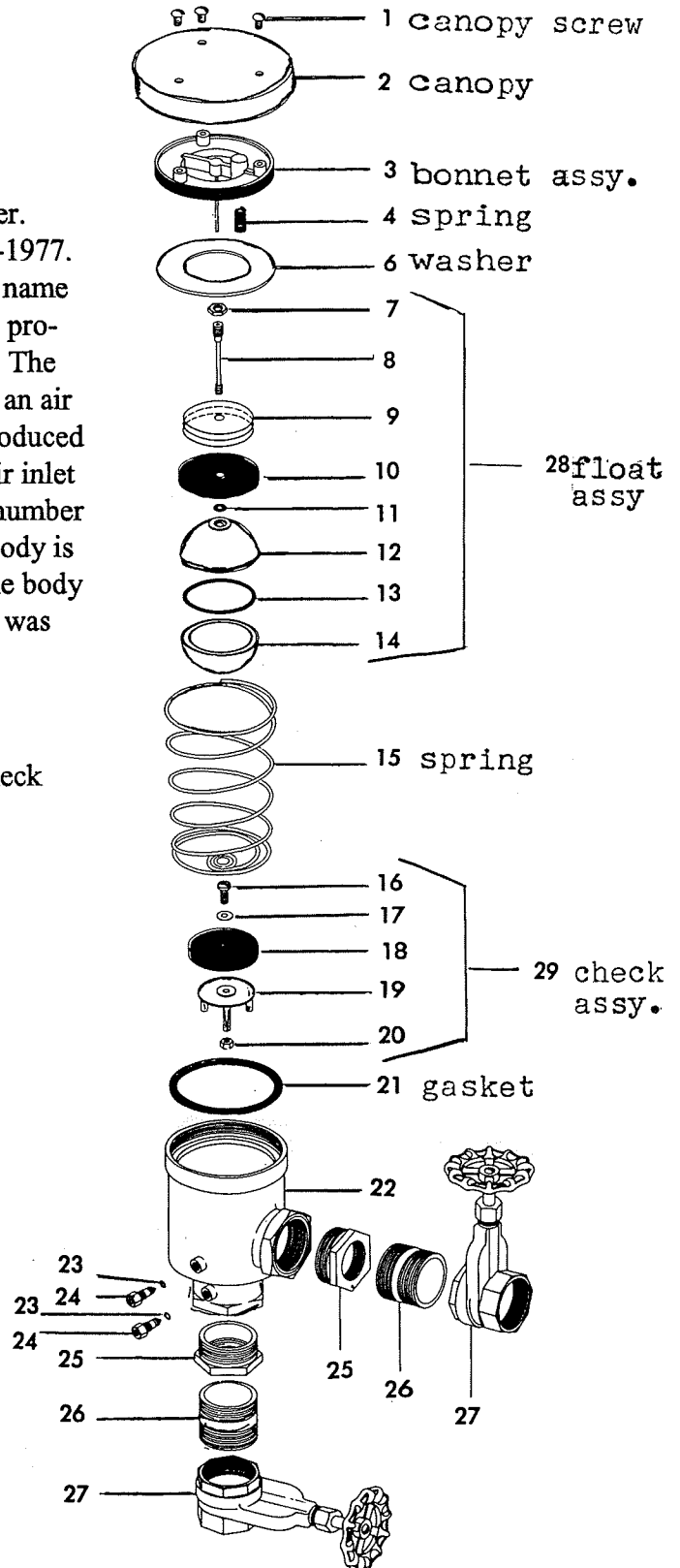

SMR 714

SIZE

2"

DESCRIPTION

This is an air inlet head that was attached to the downside of the second check of a double check assembly. This would make the double check assembly a two check pressure vacuum breaker. It utilizes the air inlet design of the 2" SMR Model 711. It was used by the Beeco Company on their double check assemblies from approximately 1960-1975.

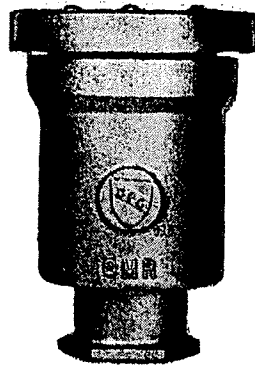
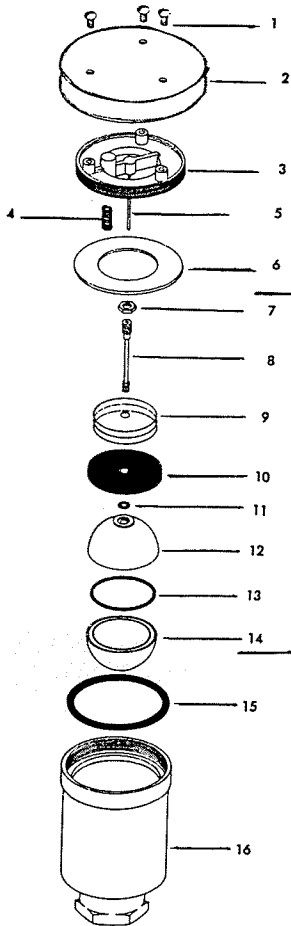

	Part Name
1	Canopy Screw
2	Canopy
3	Bonnet Assembly
4	Secondary Spring
5	Guide Rod (Only)
6	Teflon Washer
7	Nut
8	Stem Assembly
9	Back Up Washer
10	Upper Disc
11	'O' Ring, Small
12	Upper Float
13	'O' Ring, Large
14	Lower Float
15	Gasket
16	Body



SMR DHC

SIZE

3/4", 1", 1 1/2", 2"

DESCRIPTION

The DHC was a double check assembly produced from approximately 1960 to 1976. The body is of bronze construction and has a modularized in-line check design. Check seats were replaceable and the design utilized contained springs when the cover was removed. Spring tension had to be released to perform a proper repair.

BASIC REPAIR KIT

Repair kit contains all check discs and O'rings.

<u>SIZE</u>	<u>KIT NO</u>
3/4"-1"	DHC100 *◆
1 1/2"-2"	DHC200 *◆

IMPORTANT FEATURES

~ Bronze body

~ Replaceable seats

~ Contained springs

~ Modularized check assemblies

