

AMES

4001SS/ 4001

SIZE

1/2", 3/4", 1", 1 1/4", 1 1/2", 3", 4", 6"

DESCRIPTION

This is a reduced pressure assembly. Production began in 2000 and was discontinued in 2003. In 1997 the Ames Company was purchased by Watts Regulator Company. Ames began marketing the Watts 995 as the Ames 4001SS. For repair information see the Watts model 995. The 1/2"-1 1/2" size is a copper body that is nickel plated. The ball valve shut-offs are integral to the valve body. The assembly uses an external relief valve sensing line. The checks are modular in construction and accessible from the top. The relief utilizes a plastic body and is mounted under the check body. The 3"-6" body is a fabricated body made from 300 series stainless steel tubing. The relief has an external relief valve sensing line. The checks are modular in construction and accessible from the single access cover on the top. The relief valve is accessible from the same cover. The relief valve stem assembly is located between the two checks under the cover. There were 2 versions of the relief valve stem produced. A visual inspection of the nut under the dust cap can determine which version you have. The older version must be converted to the new version to properly repair. The checks are modular and use a flat check disc that is field replaceable. In the 3"-6" sizes there is a 4001SSN and a 4001SSZ model. These are the same as the 4001SS except there is a 90 degree elbow mounted between the backflow preventer flange and gate valve flange to change the installation orientation of the assembly.

BASIC REPAIR KIT

The repair kit contains disc, diaphragm, and O-rings.

<u>SIZE</u>	<u>KIT NO</u>
1/2"-3/4"	995-RT050
1"	995-RT100
1 1/4"-1 1/2"	995-RT125 ◆
3"-4"	4001SSRT300 ◆
6"	4001SSRT600 ◆

IMPORTANT FEATURES

~See Watts model 995

~1/2"-1 1/2" nickel plated copper tube body

~3"-6" stainless steel body

~Factory repair information enclosed



Reduced Pressure Principle Backflow Prevention Assembly

Model 4001

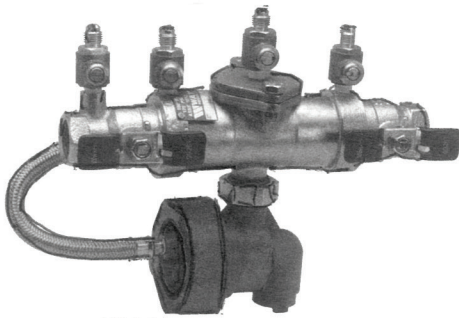

Materials

- Body: copper

Pressure – Temperature

Temperature Range: 33°F – 180°F
(5°C – 82°C) continuous
Maximum Working Pressure: 175psi
(12.06 bar)

Features

- Tubular lead free copper body creates smooth flow path and low head loss
- External/internal electroless nickel-plated body acts as an oxygen barrier for corrosion resistance
- Threaded-in check modules eliminate the use of check retainers for lower pressure loss
- Bottom mounted relief valve reduces end-to-end dimensions allowing smaller enclosures and space requirements
- Separate relief valve access cover allows the check modules to be serviced independently of the relief valve
- Unique relief valve cover nut design eliminates use of cover bolts and simplifies alignment
- Flexible stainless steel braided hose, senses supply pressure at the mid-point of the body to reduce fouling
- Check relief valve seats are replaceable without the use of special tools
- Modular check valves feature captured springs and replaceable disc rubber
- Bolted on, top entry stainless steel check valve cover features an O-ring seal to limit torque requirements
- Crush seal check module O-ring for positive seating

Dimensions – Weights

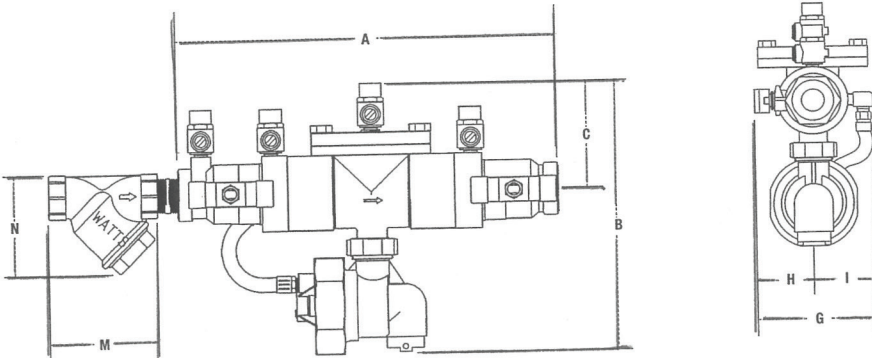

995QT

DIMENSIONS (mm)		DIMENSIONS (in.)		DIMENSIONS (mm)		DIMENSIONS (in.)		DIMENSIONS (mm)		DIMENSIONS (in.)		WEIGHT							
A	B	C	G	H	I	M	N	lbs.	kgs.										
1/2	15	9	228	7 1/4	184	2 5/8	67	3 3/8	92	1 3/8	41	2	51	3	76	3	76	5	2
3/4	20	9	228	7 1/4	184	2 5/8	67	3 3/8	92	1 3/8	41	2	51	3 1/2	89	3	76	5	2
1	25	11 1/2	292	8 1/16	205	3 5/16	84	4 1/8	105	2	51	2 1/2	54	4 3/4	121	3 1/4	83	7	3
1 1/4	32	15 3/8	390	11	279	4 1/16	113	6	152	3 3/4	82	2 3/4	69	4 1/2	114	3 1/2	89	18	8
1 1/2	40	15 3/8	390	11	279	4 1/16	113	6	152	3 3/4	82	2 3/4	69	4 3/4	124	4	102	18	8

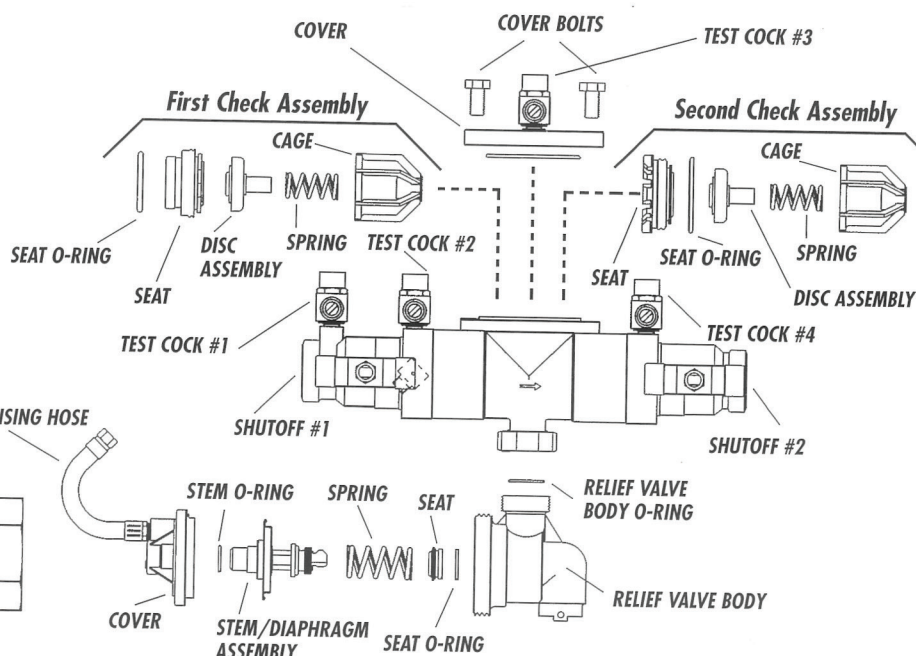
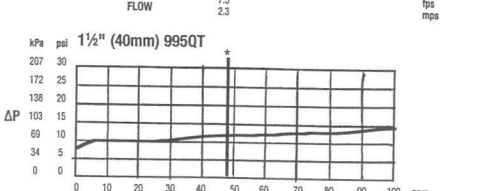
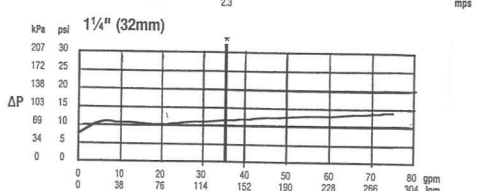
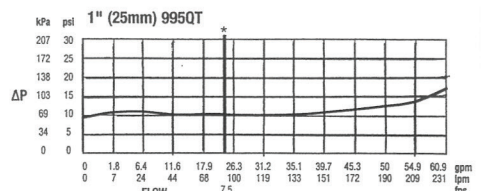
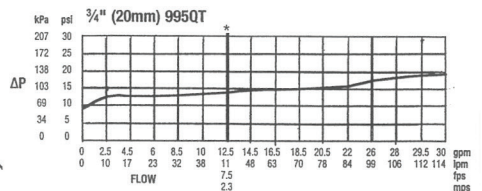
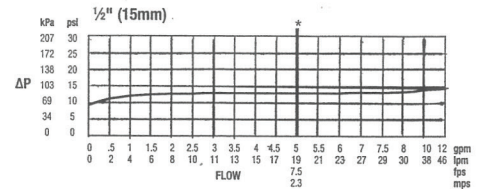

MATERIALS

All internal metal parts: 300 Series stainless steel
 Main valve body: 300 Series stainless steel
 Check assembly: Noryl
 Flange dimension in accordance with AWWA Class D



FLUID CONTROL SYSTEMS

A Division of Watts Industries, Inc.

PRESSURE - TEMPERATURE

Suitable for supply pressures up to 175 psi (12.1 bars)
 and water temperature to 140°F (60°C) continuous.

Ames 4001SS - Weights & Dimensions

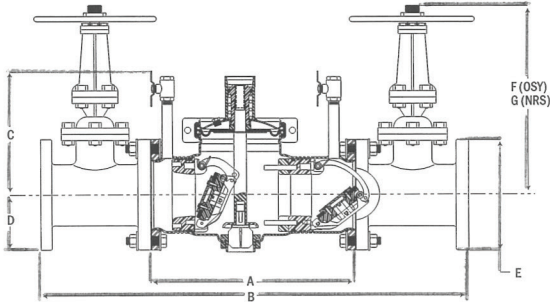

Size	Dimensions (in.)							Weight	
	A	B	C	D	E	F	G	w/Gates lbs.	w/o Gates lbs.
3	20	36.125	10.5	3.75	7.5	18.875	12.375	194	47
4	16.5	34.625	10.5	4.5	9	22.75	14.75	259	46
6	22.5	43.625	12.5	5.5	11	30.125	19	408	87

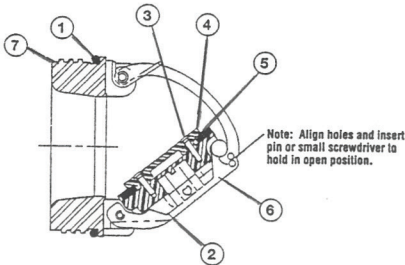
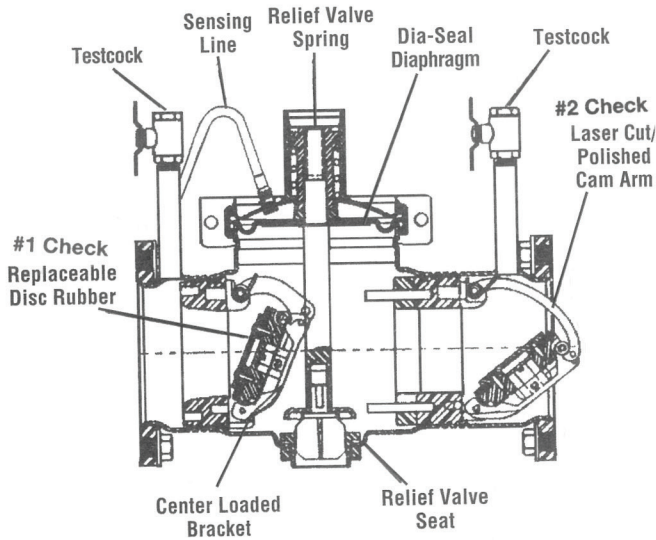

Item	Part Description
1.	1st Cam-Check O-ring (removable)
2.	Clapper Assembly (removable)
3.	Clapper Retaining Plate Screws (removable)
4.	Clapper Retainer Plate (removable)
5.	Clapper Disc (removable)
6.	Pivot Arm Pin (removable) 2 c-clips
7.	2nd Cam-Check O-ring (removable)

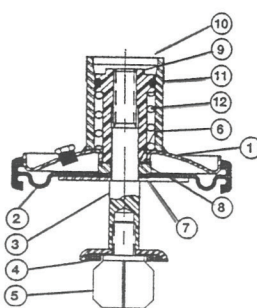

Item	Part Description
1.	Cover
2.	Diaphragm/Gasket
3.	Shaft
4.	Sealing Disc
5.	Guide, Lower
6.	O-ring
7.	Support Disc
8.	Disc, Diaphragm Stop
9.	Guide, Upper
10.	Cover, Dust
11.	O-ring, Upper
12.	Spring

4001SS

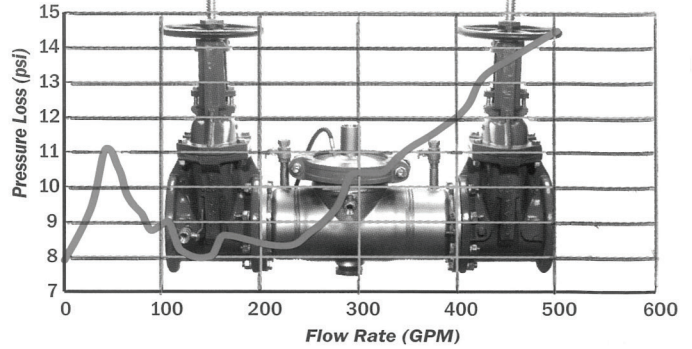

4001SS

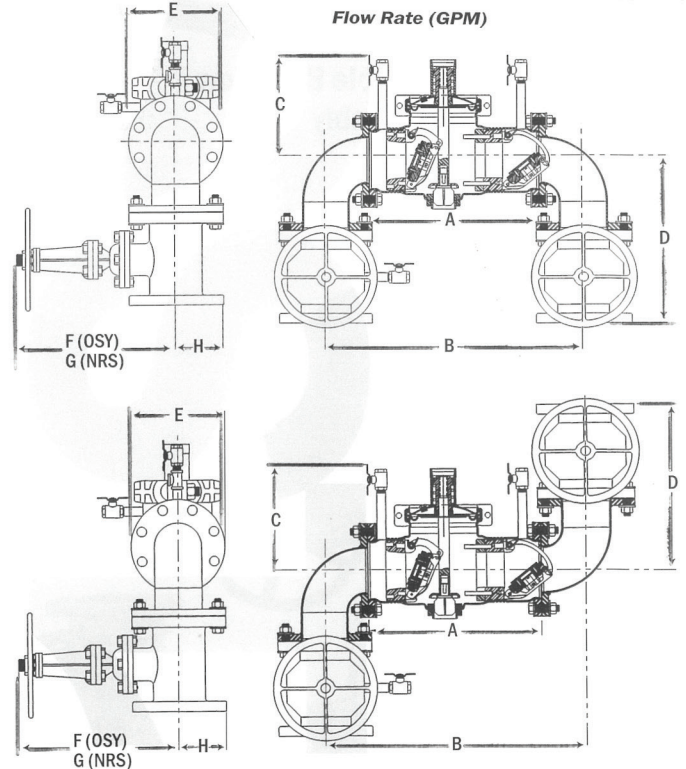
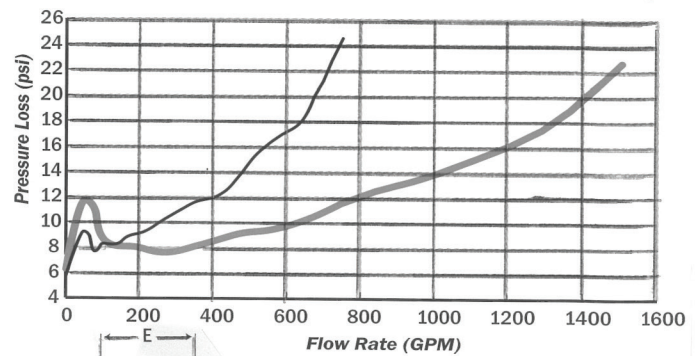

4001SSN&Z with NRS/OSY Gates

Size	Dimensions (in.)								Weight	
	A	B	C	D	E	F	G	H	w/gates* lbs.	w/o gates lbs.
3	20	29-5/8	10-1/2	12-13/16	7-1/2	18-7/8	12-3/8	3-3/4	230	83
4	16-1/2	25-1/8	10-1/2	15-13/16	9	22-3/4	14-3/4	4-1/2	312	99
6	22-1/2	35-1/8	12-1/2	18-5/16	11	30-1/8	19	5-1/2	491	170

*Includes elbows

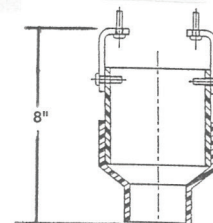

Air Gap Fitting