

# AMES 400B

## SIZE

1/2", 3/4", 1", 1 1/4", 1 1/2", 2"

## DESCRIPTION

This is a reduced pressure assembly. Production began in 2003 and was discontinued in 2013. The Ames 400B is the same as the Watts model 919. The body is made of bronze. The checks are a poppet design. Check covers unscrew from the top of the body. The check springs are not contained when the cover is removed. The relief valve utilizes an internal relief valve sensing line. There will be tension from the relief valve spring as you remove the cover. For repair information see Watts 919.

## BASIC REPAIR KIT

The repair kit contains discs, diaphragm, and O'rings

<u>SIZE</u>	<u>KIT NO</u>	<u>AIR GAP DRAIN</u>
1/4"-1/2"	919-RT050	919AGC
3/4"	919-RT075	919AGC
1"	919-RT100	919AGC
1 1/4"-1 1/2"	919-RT125	919AGF
2"	919-RT200	919AGF

## IMPORTANT FEATURES

- ~ *Poppet style checks*
- ~ *Factory repair information enclosed*



# Series 400B



## Reduced Pressure Zone Assemblies

Sizes: 3/4" - 2" (20 - 50mm)

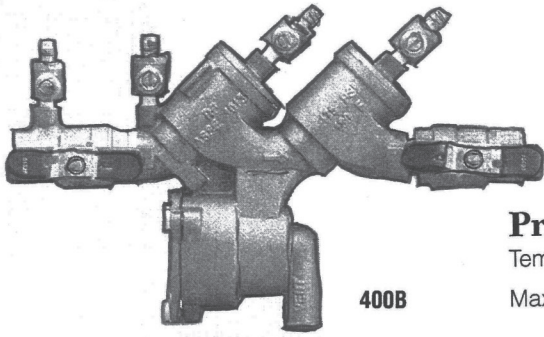

400B

### Materials

Body: Bronze

Discs: Silicone rubber

Check Seats: Replaceable polymer

Cover Bolts: Stainless steel

### Pressure — Temperature

Temperature Range: 33°F - 180°F (3°C - 82°C)

Maximum Working Pressure: 175psi (12.06 bar)

### Features

- Separate access covers for the check valves and relief valve for ease of maintenance
- Top entry-all check internals easily accessible
- All rubber elastomers of chloramine resistant material
- Check valve poppet assemblies are fully guided by innovative plastic seat guide
- Replaceable push-in check valve and relief valve seat eliminates threads from the water way
- EZ twist relief valve cover-quarter turn locking joint captures the spring load during repair to facilitate disassembly
- Innovative check valve plastic cover bushing provides trouble free guiding of the check valve poppet
- Bottom mounted relief valve provides reduced installation clearances
- Compact, space saving design
- No special tools required for servicing
- Top mounted test cocks for ease in testing and reduced installation clearances

### Dimensions and Weights

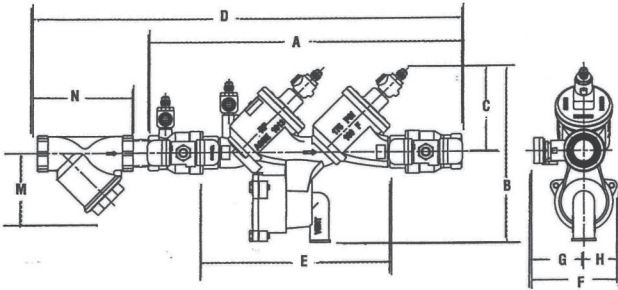

### 400B, 400B-S

SIZE (DN)	DIMENSIONS				STRAINER DIMENSIONS								WEIGHT	
	A	B	C	D	E (LF)	F	G	H	M	N	400B	400B-S		
in. mm	in. mm	in. mm	in. mm	in. mm	in. mm	in. mm	in. mm	in. mm	in. mm	in. mm	lbs. kgs.	lbs. kgs.		
3/4	20 12 1/8 307	7 7/16 188	3 1/2 88	15 1/2 393	7 11/16 195	3 5/8 92	2 1/16 52	1 9/16 40	1 1/2 41	3 3/4 81	8.3 3.7	10.0 4.5		
1	25 14 1/2 368	8 202	3 7/8 98	19 5/8 487	9 5/8 233	4 102	2 1/8 62	1 9/16 40	2 1/8 54	3 3/4 95	11.8 5.4	13.8 6.3		
1 1/4	32 18 1/8 461	11 1/8 290	5 1/8 129	23 3/4 591	11 11/16 297	5 1/8 130	2 5/8 67	2 1/2 64	2 1/2 64	4 7/8 113	22.3 10.1	26.3 11.9		
1 1/2	40 18 3/4 476	11 7/8 290	5 1/8 129	25 1/8 637	11 11/16 297	5 5/8 143	3 3/8 79	2 1/2 64	3 7/8 90	4 7/8 124	28.3 12.8	32.0 14.5		
2	50 21 1/8 535	12 1/8 307	5 7/8 142	28 3/8 732	13 3/8 340	5 15/16 151	3 7/8 87	2 1/2 64	3 7/8 90	5 15/16 151	37.3 16.9	45.0 20.4		

### Air Gaps

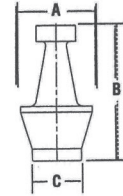

AIR GAP MODEL	SIZES	DIMENSIONS			WEIGHT	
		A	B	C	lbs.	kg.
		in. mm	in. mm	in. mm		
400B-AGC	3/4" & 1"	2 3/8 60	3 3/8 79	1 1/2 38	.63	.28
400B-AGF	1 1/2" - 2"	4 3/8 111	8 7/8 214	3 7/8 96	4.26	1.93

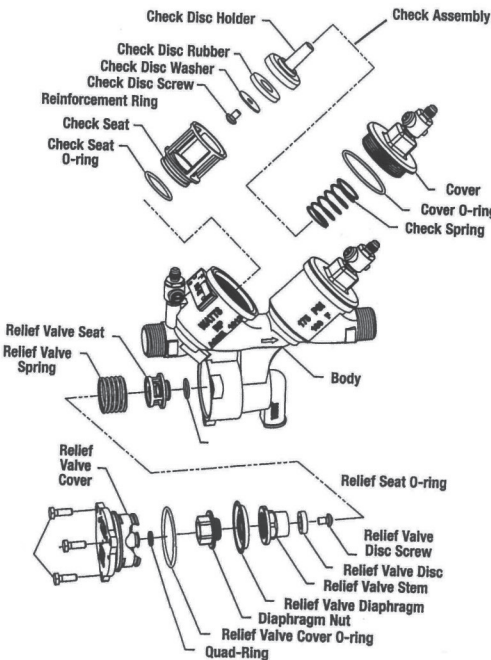

### Capacities

