

BEECO/ MIFAB FRP

SIZE

1/2", 3/4", 1", 1 1/4", 1 1/2", 2", 2 1/2", 3", 4", 6", 8", 10"

DESCRIPTION

This is a reduced pressure assembly. Production began in 2010. The 1/2"-2" size is available in a leaded or lead free bronze body. There is a single access cover on the top to access the check valves. The checks are an inline modular design and therefore the springs are contained when the cover is removed. The checks are plastic construction and utilize silicone rubber discs. The relief valve utilizes a separate cover and there will be spring tension when the cover is removed. The 2 1/2"-10" utilizes a fused epoxy coated ductile iron body. There is a single access cover for the checks attached with a groove coupling. The checks are modular and held into the body with a separate ring retainer for each check. The relief valve body is mounted under the check valve body and attached by bolts. The relief valve utilizes an external hose for the high pressure sensing line. There will be spring tension when the cover is removed.

BASIC REPAIR KIT

Repair kit contains discs, diaphragm, and O'rings

<u>SIZE</u>	<u>KIT NO</u>
1/2"-3/4"	FRPRT050 *
1"	FRPRT100 *
1 1/4"-2"	FRPRT125 *
2 1/2"-4"	FRPRT250 *
6"	FRPRT600 *
8"-10"	FRPRT800 *

IMPORTANT FEATURES

~Single access cover for check valves

~Modular check design



Location: _____



FRP

**FRIENDLY REDUCED PRESSURE
ZONE BACKFLOW 1/2" TO 2"**

Features: The checks are designed with a unique thumb screw holding in the disc to allow for easy removal of the check with a simple pair of pliers dramatically reducing part breakage during repair. The single threaded cover makes for the quickest access inside the valve in the industry. Repair parts are so modular it only takes two relief valve kits and three check repair kits to cover all sizes 1/2" through 2".

Ratings: Maximum Working Pressure 175 psi, Hydrostatic Test Pressure 350 psi, Temperature Range 33° F – 180° F. Tested and approved to ASSE® 1013 and CSA® B64.4, and is IAPMO listed.

BEECO reserves the right to make changes in material and design without formal notice and obligation.

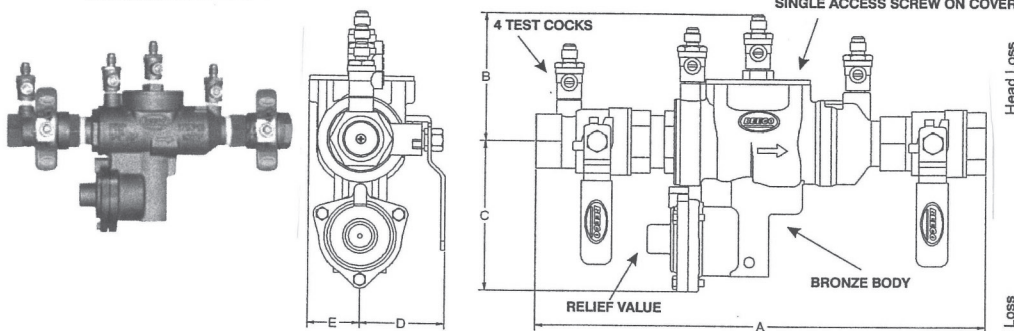

Model No.	Size	A	B	C	D	E	Weight
FRP50-QT	1/2" (13)	10 1/4" (260)	3 3/8" (86)	4" (102)	2" (51)	1 1/4" (32)	5.5 (2.5)
FRP75-QT	3/4" (19)	11 1/8" (280)	3 3/8" (86)	4" (102)	2 1/2" (64)	1 1/4" (32)	6 (2.7)
FRP1.00-QT	1" (25)	12 3/4" (320)	3 1/2" (89)	4 1/8" (105)	2 1/2" (64)	1 1/2" (38)	9 (4.1)
FRP1.25-QT	1 1/4" (32)	16 1/4" (610)	4 3/8" (111)	6 5/8" (168)	2 3/4" (70)	1 3/4" (44)	13 (5.9)
FRP1.50-QT	1 1/2" (38)	16 3/4" (425)	4 3/8" (111)	6 5/8" (168)	3 3/8" (86)	1 3/4" (44)	17 (7.7)
FRP2.00-QT	2" (51)	17 1/2" (445)	4 7/8" (124)	6 5/8" (168)	3 3/8" (86)	2 1/4" (57)	26 (11.8)

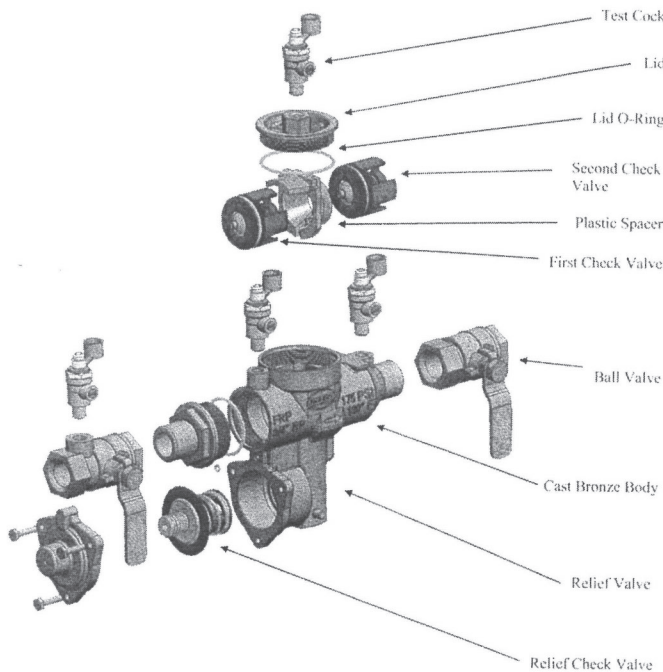
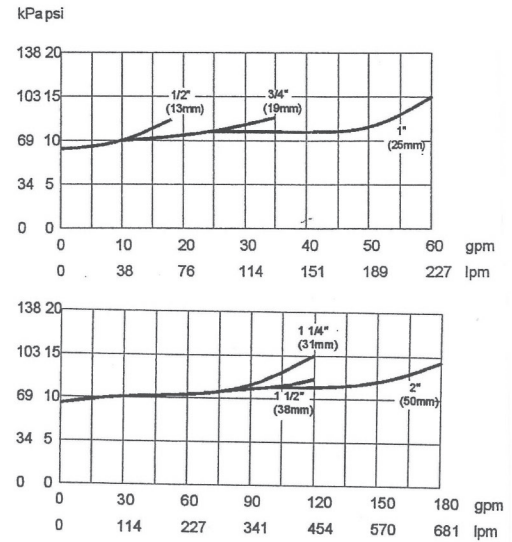

BEECO CHECK VALVE (1/2" – 2")

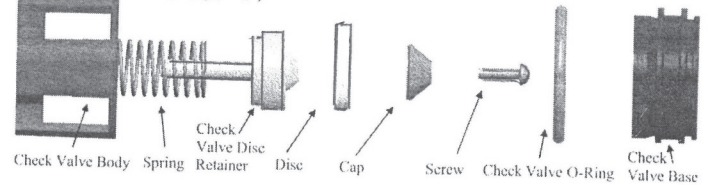

BEECO®
Distributed by: **MIFAB®**

AG **AIR GAPS**
1/2" THRU 10"

Specification: Beeco Air Gaps are custom made to fit onto the relief valves of all Beeco Friendly Reduced Pressure Backflow devices.

Function: Beeco Air Gaps provides the unobstructed, physical separation between the discharge end of a potable water supply line and an open receiving vessel.

Features: The Beeco Air Gaps are easily attached and can be either factory installed or added in the field after valve installation.

Material: The Beeco Air Gaps are made of Cast Iron and fused bonded epoxy coating to keep them rust free.

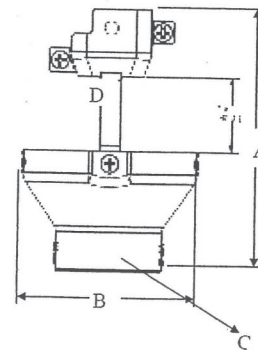

Model Number	Valve Size	A	B	C	D
AG1.00	1/2" thru 1"	4.03	2.80	1" NPT	1.00
AG2.00	1 1/4" thru 2"	6.75	4.50	2" NPT	1.90
AG3.00	2 1/2" thru 6"	10.00	5.38	3" NPT	4.75
AG4.00	8" and 10"	12.00	7.25	4" NPT	6.25

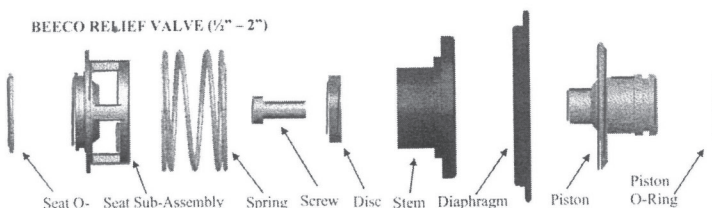

Location: _____



FRP

2 1/2" THRU 10" REDUCED PRESSURE ZONE BACKFLOW ASSEMBLIES

Specification: The BEECO Friendly Reduced Pressure Zone Backflow Preventer Valve is designed to stop the reverse of flow of a liquid into a potable water system. The proper installation of a backflow preventer must be done by a certified expert under local codes and guidelines to assure the protection of the drinking water system. The Valve shall be certified to ASSE 1013. Is Certified to cUPC and IAPMO listed.

Function: The assembly shall consist of two repairable positive seating check modules with captured springs and rubber seat discs. Service of all internal components shall be through a single easily removable cover and designed for ease of access. The valve shall have a relief valve to atmosphere.

Features: Single access cover for fast service, Swing away clamp for ease of removing checks, Modular design reducing number of spare parts, Self contained check so there is no pressure to relieve when changing the seats. The relief valve like the checks are easily repairable in line and is positioned for maximum protection in the vertical up position.

Ratings: Maximum working water pressure 175 PSI, Working temperature range 33°F-140°F. Hydrostatic test pressure 350 PSI, Flanged end connection meet ANSI B16.1 and all grooved dimensions comply with AWWA C606.

MIFAB reserves the right to make changes in material and design without formal notice or obligation.

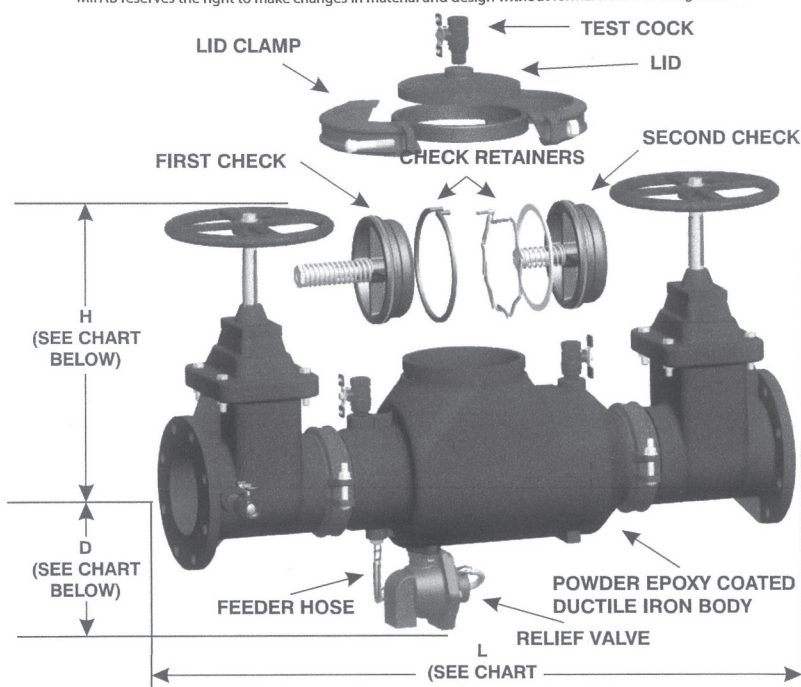

Model No.	Size	L	H OSY Open	H NRS	D
FRP2.50	2 1/2"	33.5	18.88	16.38	9.75
FRP3.00	3"	34.5	21.88	18.88	9.75
FRP4.00	4"	40.8	25.63	21.63	9.75
FRP6.00	6"	43.8	35.13	29.13	11.25
FRP8.00	8"	56.5	44.63	36.63	15.75
FRP10.00	10"	59.5	54.5	44.5	15.75

All RP devices must be installed where a drain is available to cover the discharge in event there is a backflow condition and the relief valve discharges. Discharge rates are as follows: 1/2" to 1" 5 GPM, 1 1/4" to 2" 20 GPM, 2 1/2" to 6" 20 GPM, and 8" to 10" 60 GPM.

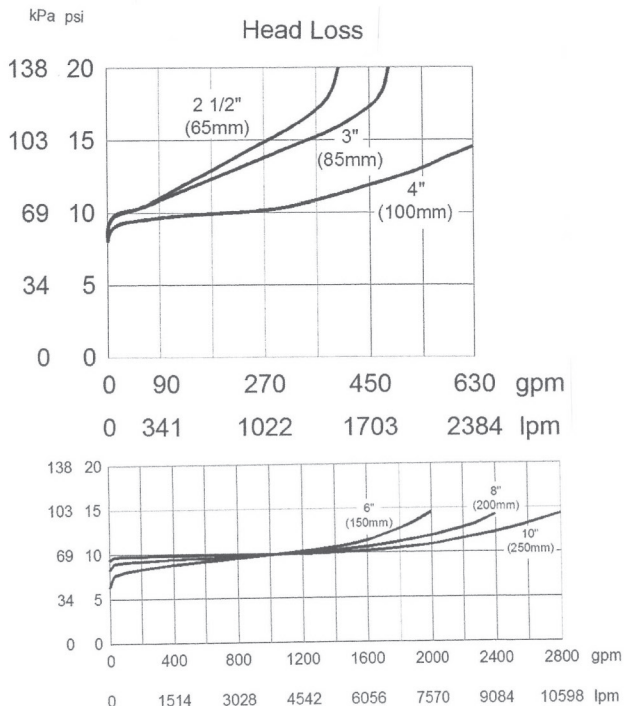

BEECO CHECK VALVE (2 1/2" - 10")

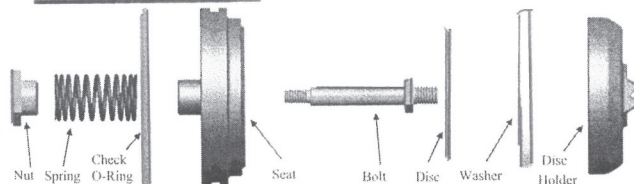

BEECO RELIEF VALVE (2 1/2" - 10")

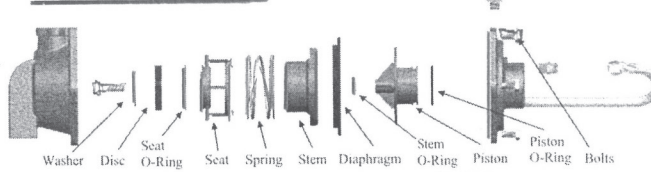

AIR GAPS
1/2" THRU 10"

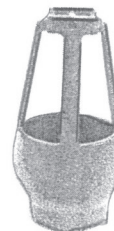

Model No.	Valve Size	A	B	C	D
AG3.00	2 1/2" thru 5"	10.00	5.38	3" NPT	4.75
AG4.00	8" and 10"	12.00	7.25	4" NPT	6.25