

ORION

80-0069/ 9-2929

SIZE

1 1/2", 2"

DESCRIPTION

This is a reduced pressure assembly. Production was originally under the Toro name and began approximately in 1976. Orion bought this design and produced it from 1980-2000. Febco bought the rights to produce this design in 2000 and discontinued it in 2001. All Orion models use a vertical piping configuration where water goes in the bottom and comes down out of the bottom. The body base is constructed of bronze with a stainless steel cover which is connected by a stainless steel band clamp. The check assemblies are modularized and are made of a plastic called celcon. All seats and springs are contained when the cover is removed. The relief valve utilizes an internal sensing line.

BASIC REPAIR KIT

Modular repair kit contains first, second, and relief valve modules, RV sensing line with nuts, and body O-ring

<u>SIZE</u>	<u>KIT NO</u>
1 1/2"-2"	900-42 * ◆

Rubber repair kit contains all rubber discs, O-rings, and gaskets

<u>SIZE</u>	<u>KIT NO</u>
1 1/2"-2"	80-0421 ◆

IMPORTANT FEATURES

- ~Vertical piping orientation
- ~Replaceable seats
- ~Contained springs
- ~Internal RV sensing line





Backflow Preventers 1 1/2" & 2"

Reduced Pressure Model

for protection of potable water supply systems when cross-connected to high hazard substances.

Characteristics

Compact-lightweight-requires less space.

Minimal pressure loss.

Internal parts of corrosion-resistant engineering plastic.

Easy in-line maintenance.

Exclusive anti-spit relief valve.

Operating pressure 150 psi.

Operating temperature 150°F maximum.

Meets performance specifications of AWWA C-506.

Approved by USC Foundation for Cross Connection Control.

I.A.P.M.O., A.S.S.E. and S.B.C.C.I. Listed

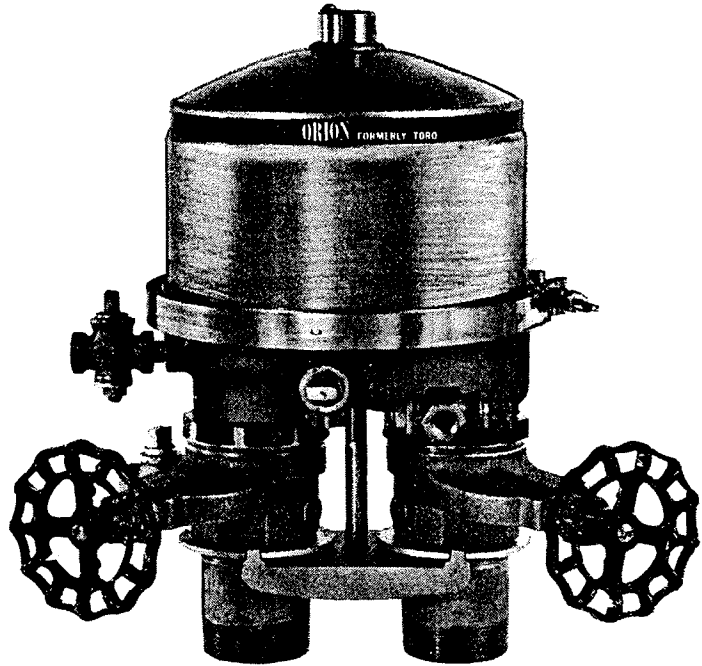

1 1/2" Model No. 80-0069

2" Model No. 9-2929

ORION BACKFLOW PREVENTERS MODEL RP 1 1/2" & 2"

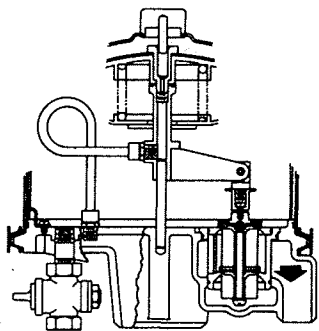
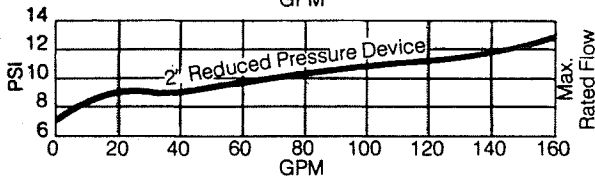
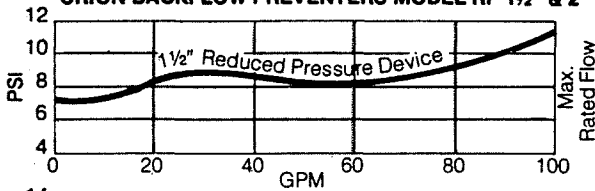

RELIEF VALVE

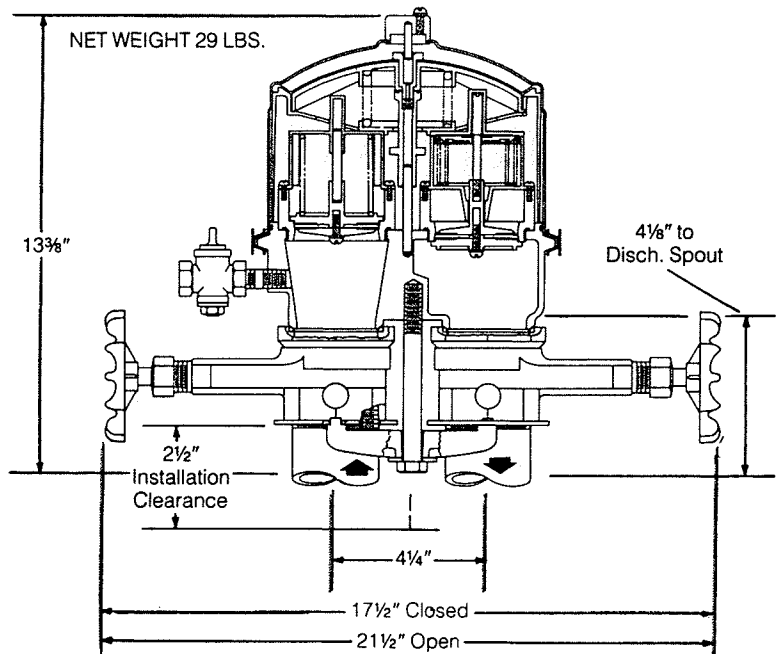

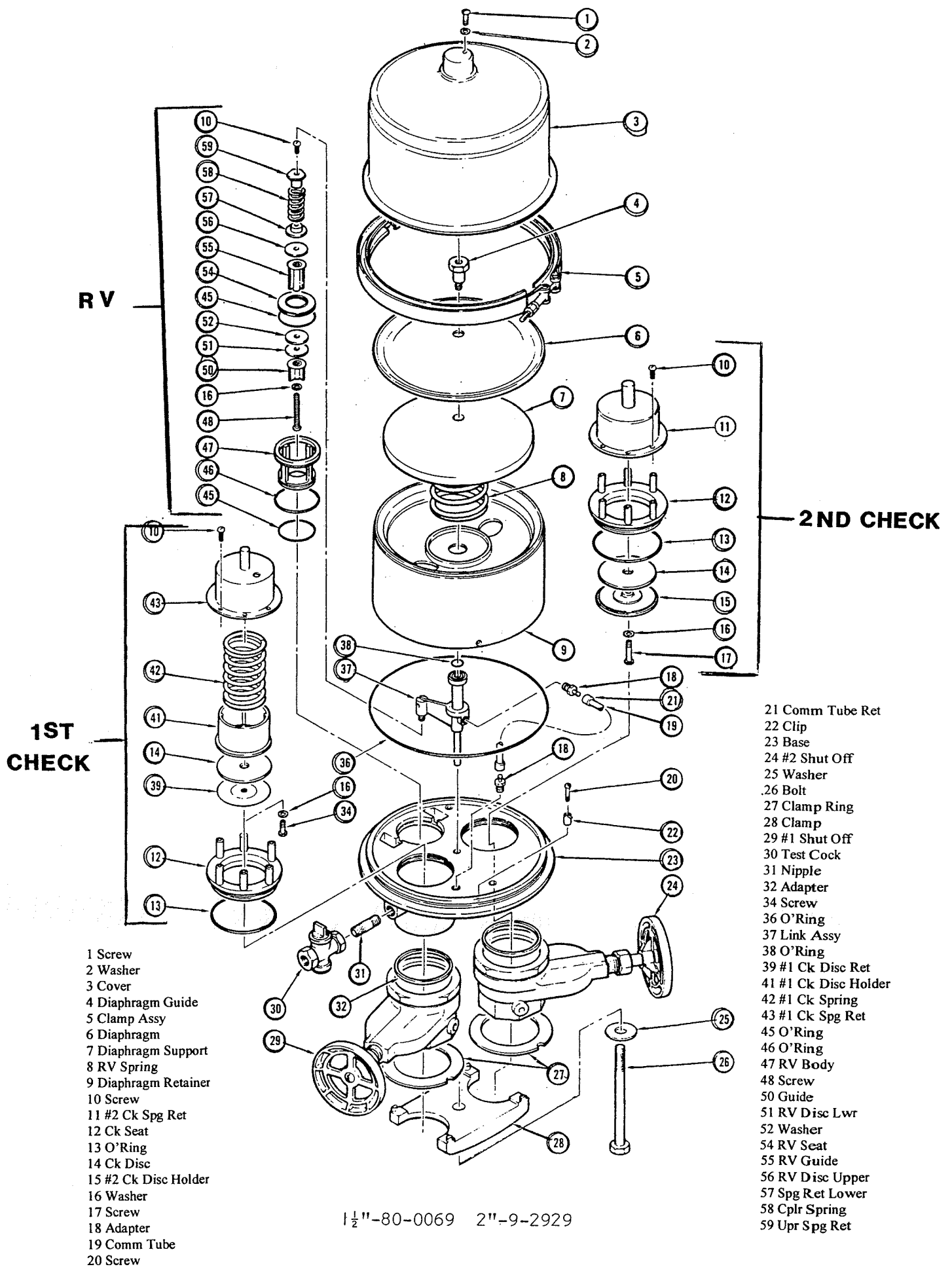

RV

1ST CHECK

2ND CHECK

- 1 Screw
- 2 Washer
- 3 Cover
- 4 Diaphragm Guide
- 5 Clamp Assy
- 6 Diaphragm
- 7 Diaphragm Support
- 8 RV Spring
- 9 Diaphragm Retainer
- 10 Screw
- 11 #2 Ck Spg Ret
- 12 Ck Seat
- 13 O'Ring
- 14 Ck Disc
- 15 #2 Ck Disc Holder
- 16 Washer
- 17 Screw
- 18 Adapter
- 19 Comm Tube
- 20 Screw

- 21 Comm Tube Ret
- 22 Clip
- 23 Base
- 24 #2 Shut Off
- 25 Washer
- 26 Bolt
- 27 Clamp Ring
- 28 Clamp
- 29 #1 Shut Off
- 30 Test Cock
- 31 Nipple
- 32 Adapter
- 34 Screw
- 36 O'Ring
- 37 Link Assy
- 38 O'Ring
- 39 #1 Ck Disc Ret
- 41 #1 Ck Disc Holder
- 42 #1 Ck Spring
- 43 #1 Ck Spg Ret
- 45 O'Ring
- 46 O'Ring
- 47 RV Body
- 48 Screw
- 50 Guide
- 51 RV Disc Lwr
- 52 Washer
- 54 RV Seat
- 55 RV Guide
- 56 RV Disc Upper
- 57 Spg Ret Lower
- 58 Cplr Spring
- 59 Upr Spg Ret

1 1/2"-80-0069 2"-9-2929