

# WATTS

## 800 M4/ LF800 M4/ 800 M4-FR

### SIZE

1/2", 3/4", 1", 1 1/4", 1 1/2", 2"

### DESCRIPTION

This is a pressure vacuum breaker. Production began in 1994. This is a bronze bodied unit. In 2010 a LF800M4 model was introduced which was constructed of lead free bronze. The check spring is contained when the bonnet is removed. The check seat is replaceable. A seat removal tool is needed to change the seat. The test cocks for this model are located on the ball valves and not on the assembly body. The 800M4 is a redesign of the 800M2 and 800M3 series with the only difference being the incorporation of a replaceable check seat. In 1995 the 800 M4 FR model was introduced. This model contains a small relief valve built into the air inlet float to prevent damage if the assembly froze.

### BASIC REPAIR KIT

Repair kit contains the rubber disc and O-rings.

<u>SIZE</u>	<u>800 M4 KIT NO</u>
1/2"-3/4"	800M4-RT050
1"	800M4-RT100
1 1/4"-2"	800M4-RT125

### IMPORTANT FEATURES

- ~Bronze body*
- ~Contained check spring*
- ~Test cocks are mounted on ball valve*
- ~Factory repair information enclosed*



# Series 800M4

## Anti-Siphon Pressure Vacuum Breaker

Sizes: 1/2", 3/4", 1", 1 1/4", 1 1/2", 2"

### Features

- Replaceable plastic seat
- Easy maintenance of internal parts
- Serves as an anti-siphon valve
- Ball valve test cocks for easy testing to insure proper operation
- Quarter-turn ball valve shutoffs
- "T" handles on 1/2" - 1"

### Pressure - Temperature

Working Temp: 33°F - 140°F  
 Max. Pressure: 150 PSI  
 Min. Pressure: 15 PSI

### Materials

Vent Disc — Silicone rubber  
 Disc Holder Float — Polyethylene  
 Check Valve Disc — Silicone rubber  
 Check Valve Seat — Plastic - Noryl  
 Body — Bronze  
 Shutoff Valves — Quarter-turn ball type

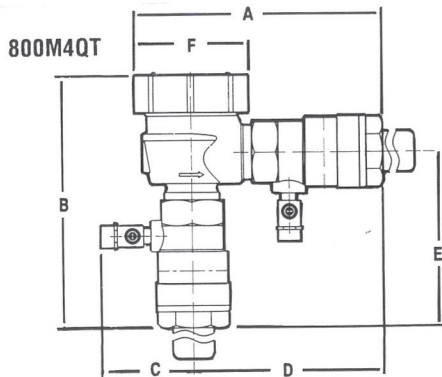
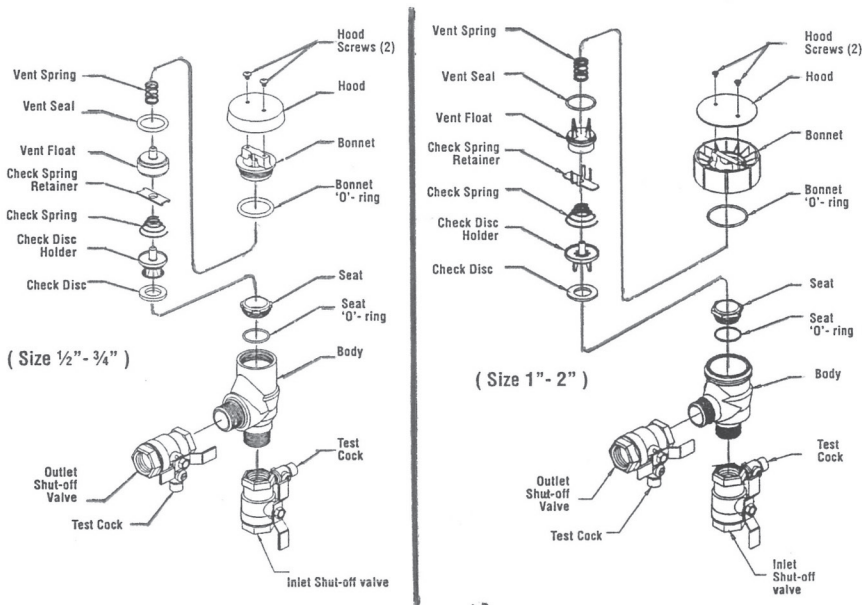

No.	Size (In.)	Dimensions (In.)						Weight (lbs.)
		A	B	C	D	E	F	
800M4-QT	1/2	5	6 3/16	2 1/4	3 7/8	3 1/16	2 1/4	3 1/16
800M4-QT	3/4	5 1/4	6 1/2	2 3/8	4 1/8	4	2 1/4	3 3/8
800M4-QT	1	4 7/8	7 1/2	2 5/8	3 3/16	2 11/16	3 7/16	5
800M4-QT	1 1/4	8 7/16	9	2 3/4	6 1/8	5 3/4	5	10
800M4-QT	1 1/2	8 7/8	9 3/8	2 7/8	6 3/8	6 1/8	5	13
800M4-QT	2	9 5/8	9 5/8	3 1/8	6 15/16	6 3/8	5	16

