

WATTS 800

SIZE

1/2", 3/4", 1", 1 1/4", 1 1/2", 2"

DESCRIPTION

This is a pressure vacuum breaker assembly. This assembly was produced from 1982-1993. The valve body is made of bronze. The check seat is cast into the body and is not replaceable. The springs are contained when the bonnet is removed. The check spring tension must be released for proper repair.

BASIC REPAIR KIT

The repair kit contains check rubber disc, float disc, and bonnet O-ring.

<u>SIZE</u>	<u>KIT NO</u>
1/2"	800-RT050
3/4"	800-RT050
1"	800-RT050
1 1/4"	800-RT125
1 1/2"	800-RT125
2"	800-RT125

IMPORTANT FEATURES

~Bronze body

~Check seat is not replaceable

~Springs are contained



Series 800QT

Anti-Siphon Pressure Vacuum Breakers

FEATURES

- Easy maintenance of internal parts.
- With resilient seated quarter turn ball valve shut offs
- Test cocks for easy testing to insure proper operation.
- No special tools required for servicing.

PRESSURE - TEMPERATURE

Working Temperature: 33°F to 140°F

Max. Pressure _____ 150 PSI

Min. Pressure _____ 15 PSI

MATERIALS

Bonnet	Plastic
Vent Disc	Silicone Rubber
Disc Holder Float	Polyethylene
Check Valve Disc	Silicone Rubber
Check Valve Seat	Bronze
Body	Bronze

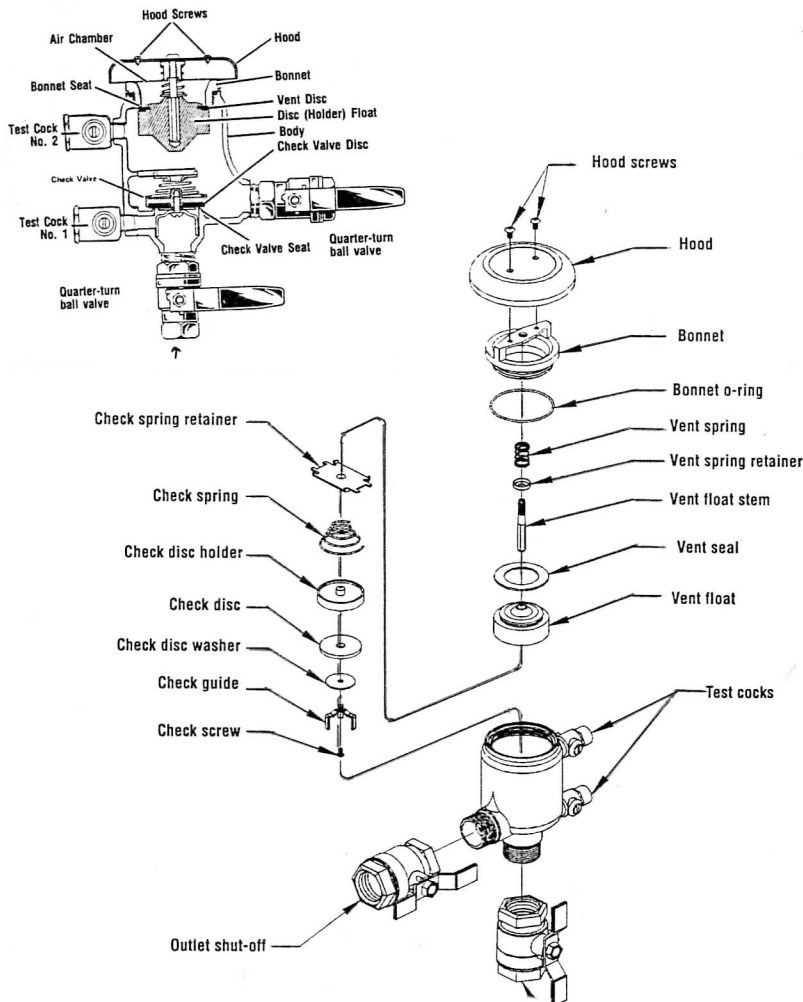

CAPACITY

No. 800 sizes 1/2", 3/4", 1"

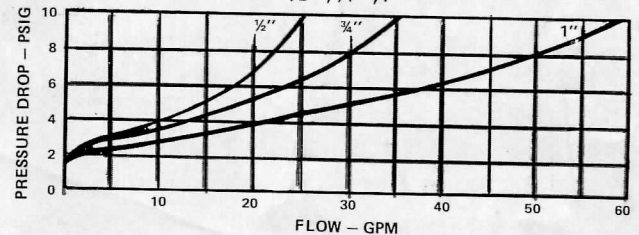

No. 800 sizes 1 1/4", 1 1/2", 2"

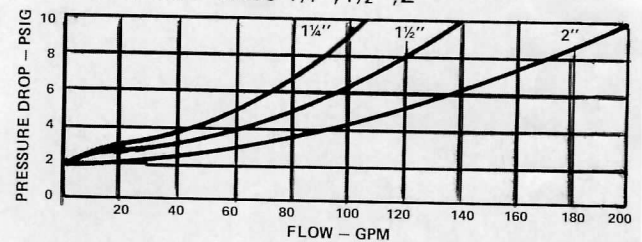

DIMENSIONS-WEIGHTS

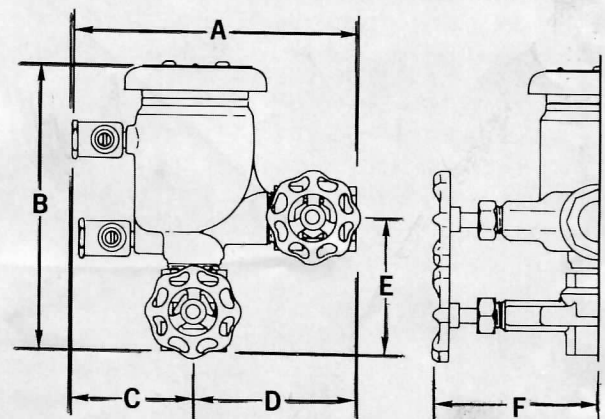

No. 800	A	B	C	D	E	F	Weight
1/2"	7 1/8"	7 3/4"	3 1/8"	4 5/8"	4 1/8"	3 3/8"	6 1/2 lbs.
3/4"	7 1/8"	7 1/8"	3 1/8"	4"	3 7/16"	3 3/4"	6 3/4 lbs.
1"	7 1/8"	7 1/8"	3 1/8"	4"	3 11/16"	4 3/8"	7 3/8 lbs.
1 1/4"	10 3/16"	10 15/16"	4 1/8"	6 1/16"	5 15/32"	4 7/8"	18 lbs.
1 1/2"	10 3/16"	10 15/16"	4 1/8"	6 1/16"	5 3/4"	5 1/2"	19 1/8 lbs.
2"	10 3/8"	11 1/8"	4 1/8"	6 1/4"	6 1/8"	6 3/8"	21 1/8 lbs.