

# WILKINS 975 XL3

## SIZE

1/2", 3/4", 1", 1 1/4", 1 1/2", 2"

## DESCRIPTION

This is a reduced pressure backflow prevention assembly. Production began in 2022. The body is made of a lead free bronze alloy. A single bolted cover allows access to both check assemblies. The springs are contained when the cover is removed. Both checks are attached to each other and come out of the body in one cartridge. The two check assemblies are disassembled by holding the cartridge and twisting the 2nd check spring retainer releasing the 2nd check and then twisting the 2nd check seat to release the first check assembly. The check discs are made of silicone rubber. The hardware plastic parts of the check cartridge are made of Noryl. The relief valve cover is bolted to the body and the relief valve spring tension is not contained when the cover is removed. The check seat is replaceable.

## BASIC REPAIR KIT

Repair kit contains all discs, diaphragm, and O' rings.

| <u>SIZE</u>     | <u>KIT NO</u> | <u>AIR GAP DRAIN</u> |
|-----------------|---------------|----------------------|
| 1/2"-3/4"       | RK12-975XL3R  | AG8                  |
| 1"              | RK1-975XL3R   | AG8                  |
| 1 1/4" - 1 1/2" | RK114-975XL3R | AG4                  |
| 2"              | RK2-975XL3R   | AG5                  |

## IMPORTANT FEATURES

- ~Lead free bronze body
- ~Both checks attached together
- ~Factory repair information enclosed





# Model 975XL3

## Reduced Pressure Principle Assembly

### Materials

|                    |  |
|--------------------|--|
| Main valve body    | Low Lead Cast Bronze ASTM B 584                        |
| Access covers      | Low Lead Cast Bronze ASTM B 584                        |
| Fasteners          | Stainless Steel, 300 Series                            |
| Elastomers         | Silicone (FDA Approved)<br>Buna Nitrile (FDA Approved) |
| Polymers           | Noryl™   |
| Springs            | Stainless Steel, 300 Series                            |
| Ball valve handles | Stainless Steel  |

### Features

|                                   |                                    |
|-----------------------------------|------------------------------------|
| Sizes:                            | 1/2", 3/4", 1", 1 1/4", 1 1/2", 2" |
| Minimum working water pressure    | 25 PSI                             |
| Maximum working water pressure    | 175 PSI                            |
| Minimum working water temperature | 33°F                               |
| Maximum working water temperature | 180°F                              |
| Hydrostatic test pressure         | 350 PSI                            |
| Threaded end connections (FNPT)   | ANSI B1.20.1                       |



### Flow Characteristics

\*Rated Flow (established by approval agencies)

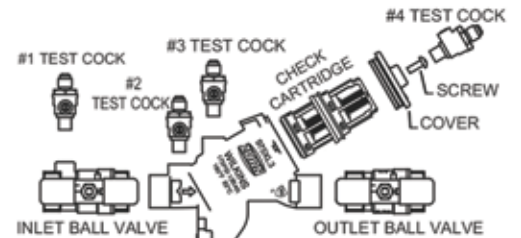
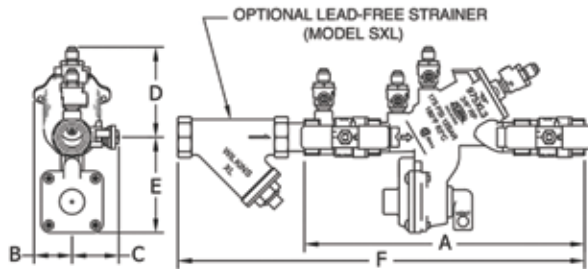
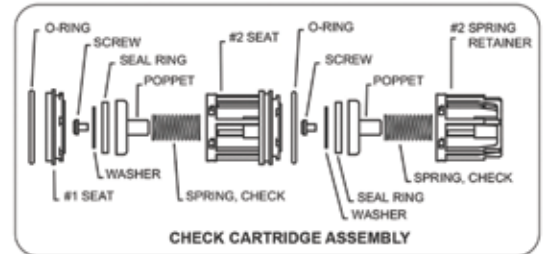
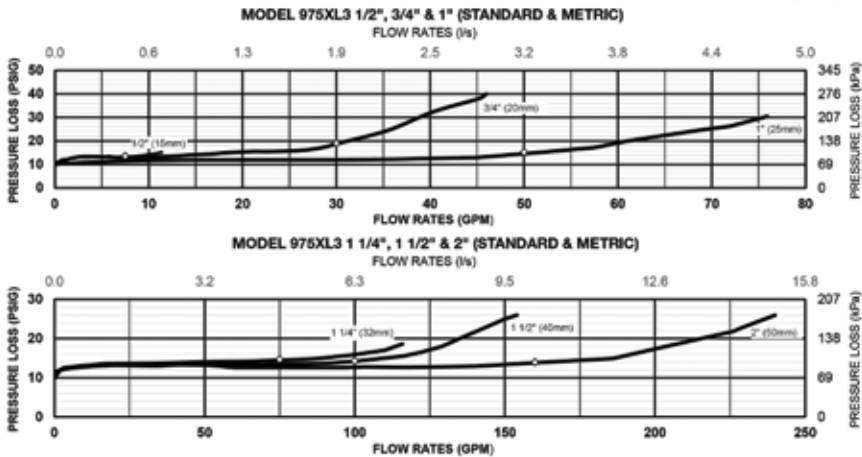

### Dimensions & Weights (do not include pkg.)

| MODEL SIZE | DIMENSIONS (approximate) |          |     |         |     |         |     |         |     |        |     |         | WEIGHT           |    |     |
|------------|--------------------------|----------|-----|---------|-----|---------|-----|---------|-----|--------|-----|---------|------------------|----|-----|
|            | A                        |          | B   |         | C   |         | D   |         | E   |        | F   |         | WITH BALL VALVES |    |     |
|            | in.                      | mm       | in. | mm      | in. | mm      | in. | mm      | in. | mm     | in. | mm      | lbs.             | kg |     |
| 1/2        | 15                       | 9 5/16   | 237 | 1 3/8   | 35  | 1 1/2   | 38  | 3 7/32  | 82  | 3 3/8  | 86  | 13 1/16 | 332              | 4  | 1.8 |
| 3/4        | 20                       | 10       | 254 | 1 3/8   | 35  | 1 11/16 | 43  | 3 7/32  | 82  | 3 3/8  | 86  | 14 1/8  | 359              | 4  | 1.8 |
| 1          | 25                       | 11 13/16 | 300 | 1 9/16  | 40  | 1 15/16 | 49  | 3 7/16  | 87  | 3 1/2  | 89  | 16 3/16 | 412              | 6  | 2.7 |
| 1 1/4      | 32                       | 15 9/16  | 396 | 1 9/16  | 40  | 2 1/2   | 64  | 4 1/16  | 104 | 5 3/16 | 133 | 21 1/8  | 537              | 15 | 6.8 |
| 1 1/2      | 40                       | 15 11/16 | 399 | 1 9/16  | 40  | 3 1/8   | 79  | 4 1/16  | 104 | 5 3/16 | 133 | 22 3/8  | 569              | 16 | 7.3 |
| 2          | 50                       | 17 7/8   | 454 | 1 15/16 | 49  | 3 1/2   | 89  | 4 15/16 | 126 | 6 5/8  | 169 | 25 7/8  | 657              | 22 | 10  |

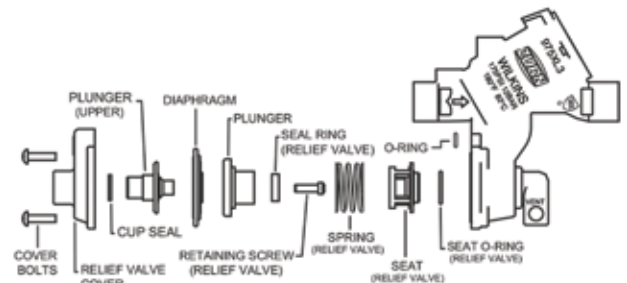

Zurn Industries, LLC | Wilkins  
1747 Commerce Way, Paso Robles, CA U.S.A. 93446 Ph. 855-663-9876, Fax 805-238-5766  
In Canada | Zurn Industries Limited  
7900 Goreway Drive, Unit 10, Brampton, Ontario L6T 9W6, 877-892-5216  
www.zurn.com

Rev. D  
Date: 9/22  
Document No. BF-975XL3  
Product No. Model 975XL3  
Patent zurn.com/patents